

FINAL PROGRAM

PRISM 9TH ANNUAL MEETING



HOUSTON, TX • JANUARY 27-29, 2022
ROYAL SONESTA HOUSTON GALLERIA





Where the **world's best athletes** come for orthopedic care.

As the Official Pediatric Medicine provider for Team USA, the Orthopedics & Sports Medicine Program at Texas Children's Hospital is dedicated to keeping athletes in the game by staying focused on our winning game plan. Our interdisciplinary approach brings together a team of sports medicine physicians, orthopedic surgeons, pediatric and musculoskeletal radiologists, sports-focused physical therapists and dietitians, and other sub-specialists to treat acute and chronic sports injuries.

Join the team at texaschildrens.org/sportsmed.

Where *Tomorrow* gets better.



WELCOME TO TEXAS!

We are delighted to have you join us for the 9th annual Pediatric Research in Sports Medicine meeting in Houston! After a prolonged pause from in-person meetings, we are thrilled to bring us back together, applying health and safety strategies to ensure your comfort in participating. We're glad you're here!

This year's scientific program features the presentation of more than 150 original abstracts as podium, poster and ePosters, representing diverse and innovative contributions to important topics in Sports Medicine. In addition to exceptional scientific research sessions, PRISM's 9th Annual Meeting will once again feature outstanding keynote speakers that unite our shared goals and energize our work. Aligned with our mission, the annual meeting offers the opportunity to strengthen existing relationships and build new relationships with multidisciplinary attendees inside and outside of your profession who work to advance research and clinical practice, and most importantly, improve outcomes for our pediatric patients. A focus of the planning committee this year was to provide opportunities to members in all stages of their careers while at the same time recognizing the diversity of the organization. In addition, we continue to look outside our organization to build partnerships with other organizations who share similar missions and visions.

Highlights of the meeting include 13 instructional courses (the most ever at a PRISM Annual Meeting!), 3 outstanding keynote speakers who each have made a significant impact in sports medicine, and over 70 podium abstract presentations. There is sure to be something for everyone. Our objective in creating the scientific program for the 2022 annual meeting was to recognize the diversity in our membership through building collaborative relationships while at the same time bringing the PRISM membership a step closer to achieving excellence in pediatric sports medicine research. Each year, the quality of the research submitted to the meeting increases and this year is no exception. This meeting would not be possible without all of the hard work, commitment, and enthusiasm to advancing the world of pediatric sports medicine by each of you, and for that, we Thank You! As always, we have a packed agenda over the three days, but have made an effort to provide opportunities for you to also enjoy time to network and take in all of what Houston has to offer. We truly look forward to seeing you in Houston!

Your 2022 Scientific Program Committee Chairs,

Scott McKay, MD & Traci Snedden, PhD, RN, CPNP

WELCOME

The PRISM 9th Annual Meeting is designed to provide high-quality dissemination of information in the basic sciences, prevention, diagnosis, treatment, and technological advances in the multi-disciplinary areas of sports medicine for children and adolescents. The Scientific Program Committee has worked hard to provide a diverse, innovative and well-rounded program that incorporates feedback from previous Annual Meetings. As a result, we are pleased to offer you three full days of multidisciplinary education, engaging experts in the field of pediatric sports medicine, and collaboration opportunities.

PRISM MISSION

The purpose of PRISM is to lead interdisciplinary research, education and advancement in pediatric and adolescent sports medicine.

TARGET AUDIENCE

The target audience for the PRISM 9th Annual Meeting includes athletic trainers, physical therapists, mid-level providers, radiologists, sports medicine providers, orthopedic surgeons, orthotists, rehab engineers, kinesiologists, nutritionists, educators, administrators, researchers, and all others concerned with pediatric and adolescent sports medicine.

ANNUAL MEETING OBJECTIVES

Upon completion of this activity, participants should be able to:

- Discuss the diagnosis & multidisciplinary management of common pediatric and adolescent sports related injuries.
- Establish treatment guidelines and algorithms for working with childhood athletes and their families.
- Examine multiple evidence based approaches to treating pediatric sports concerns.
- Explore clinical approaches to the injured athlete throughout their continuum of care.
- Evaluate effective ways to improve patient care and reduce lifelong sequelae of sports injuries.

MEETING AT A GLANCE

THURSDAY, JANUARY 27, 2022

8:00 AM – 12:00 PM	Precourse: Youth Para Sports Medicine: An Interactive Course for All Pediatric Sports Medicine Clinicians
8:00 AM – 12:00 PM	ROCK Meeting
12:00 – 1:30 PM	Lunch
12:30 – 1:30 PM	PRISM Committee meetings
2:00 – 2:10 PM	Welcome and Introduction to Scientific Program
2:10 – 2:45 PM	Allen Anderson Lectureship: Hank Chambers, MD - PRISM: Did We Really Need Another Organization?
2:45 – 3:45 PM	Instructional Course 1: Hot off the Press- Top 5 in 60
3:45 – 4:00 PM	Exhibit and Poster Viewing Break
4:00 – 4:45 PM	Scientific Session 1: Concussion 1 Scientific Session 2: ACL General
4:45 – 5:30 PM	Scientific Session 3: Knee Scientific Session 4: Outcome Measures
5:30 – 5:45 PM	Exhibit and Poster Viewing Break
5:45 – 7:00 PM	Complex Cases and Spirited Debates: Christina Master, MD

FRIDAY, JANUARY 28, 2022

7:00 – 8:00 AM	Breakfast
7:30 – 8:00 AM	PRISM Membership Business Meeting
8:00 – 9:00 AM	Instructional Course 2: Care of the Pediatric and Adolescent Female Athlete
9:00 – 9:45 AM	Scientific Session 5: Mental Health and Sleep
9:45 – 10:30 AM	Keynote: Cheri Blauwet, MD - Bringing Your Passion to Work: The Evolution of a Career in Paralympic Sports Medicine
10:30 – 10:45 AM	Sponsor Highlight: Texas Children's Hospital
10:45 – 11:00 AM	Poster and Exhibit Viewing Break
11:00 – 11:45 AM	Scientific Session 6: Meniscus Scientific Session 7: Concussion 2
11:45 AM – 1:00 PM	Lunch
11:55 AM – 12:55 PM	RIG Meetings 1 (with lunch)
1:00 – 2:00 PM	Instructional Course 3: A Multi-Disciplinary Approach to Psychological Readiness and Return to Sport Following Anterior Cruciate Ligament Reconstruction Instructional Course 4: Caring for Unique Populations in Pediatric Sports Medicine Instructional Course 5: Posterior Ankle Impingement In Pediatric Population: Diagnosis And Management
2:15 – 3:00 PM	Scientific Session 8: ACL Surgery Scientific Session 9: Concussion 3
3:00 – 4:00 PM	Instructional Course 6: Mental Health in the Young Athlete: A multidisciplinary perspective Instructional Course 7: ALL, LET, ACL: Alphabet Soup of the Anterolateral Knee
4:00 – 4:15 PM	Exhibit Viewing Break
4:15 – 5:15 PM	Scientific Session 10: Patellofemoral Instability Scientific Session 11: Special Topics
5:15 – 6:15 PM	Instructional Course 8: Surgical Treatment of Patellofemoral Instability Risk Factors in Skeletally Immature Athlete Instructional Course 9: Manual Therapy for the Pediatric Athlete
6:30 – 7:30 PM	Poster, Exhibit & Networking Reception

SATURDAY, JANUARY 29, 2022

7:00 – 8:00 AM	Breakfast
7:15 – 7:45 AM	Student and APP networking
8:00 – 9:00 AM	Instructional Course 10: Addressing Disparities in Pediatric Sports Medicine
9:00 – 9:30 AM	PRISM Awards and Gavel Exchange
9:30 – 10:15 AM	Keynote: Billy Hawkins, PhD - Sport, Culture, and a Need for a Social Justice Orientation
10:15 – 10:30 AM	Exhibit and Poster Viewing Break
10:30 – 11:30 AM	Scientific Session 12: Top 12 posters
11:30 AM – 1:00 PM	Lunch
11:45 AM – 12:45 PM	RIG Meetings 2
1:00 – 2:00 PM	Instructional Course 11: Understanding Patient Perceptions: Considering Psychosocial Barriers for Recovery in Patients with Knee Injury Instructional Course 12: Controversies in Adolescent Hip Preservation: Physical Therapy vs. Arthroscopic vs. Open Surgical Treatment Instructional Course 13: Multi-Specialty Collaborative Approach to Post-Graduate Education
2:00 – 2:15 PM	Exhibit and Poster Viewing Break
2:15 – 3:00 PM	Scientific Session 13: Lower Extremity Scientific Session 14: Pain/Upper Extremity
3:00 – 4:00 PM	Scientific Session 15: ACL Rehab Scientific Session 16: ACL Anatomy

Print program information is up to date as of 1/10/22. Presenters are subject to change.

CONTINUING EDUCATION (CE) LANGUAGE

PEDIATRIC RESEARCH IN SPORTS MEDICINE PRISM 9TH ANNUAL MEETING

Live: January 27, 2022 - January 29, 2022

Enduring: February 17, 2022 - February 17, 2023

Houston, TX

ACCREDITATION STATEMENT



JOINTLY ACCREDITED PROVIDER™
INTERPROFESSIONAL CONTINUING EDUCATION

In support of improving patient care, this activity has been planned and implemented by Amedco LLC and Pediatric Research in Sports Medicine (PRISM).

Amedco LLC is jointly accredited by the Accreditation Council for Continuing Medical Education (ACCME), the Accreditation Council for Pharmacy Education

(ACPE), and the American Nurses Credentialing Center (ANCC), to provide continuing education for the healthcare team.

PHYSICIANS (ACCME) CREDIT DESIGNATION

Amedco LLC designates this live to enduring activity for a maximum of 20.50 live / 32.25 enduring *AMA PRA Category 1 Credits*™. Physicians should claim only the credit commensurate with the extent of their participation in the activity.

NURSES (ANCC) CREDIT DESIGNATION

Amedco LLC designates this activity for a maximum of 20.50 live / 32.25 enduring ANCC contact hours.

ATHLETIC TRAINERS (BOC) CREDIT DESIGNATION

Amedco (BOC AP#: 4008163) is approved by the Board of Certification, Inc. to provide continuing education to Athletic Trainers (ATs). This program is eligible for a maximum of 20.50 live / 32.25 Category A hours/CEUs. ATs should claim only those hours actually spent in the educational program.

PHYSICAL THERAPY BOARD OF CALIFORNIA (CA PT)

This course will be submitted for review to the Physical Therapy Board of California. No determination of creditworthiness has yet been made and, if approved, total credits may vary from other boards.

NEW JERSEY STATE BOARD OF PHYSICAL THERAPY EXAMINERS (NJPT)

This course will be submitted for review to the New Jersey State Board of Physical Therapy Examiners. No determination of creditworthiness has yet been made and, if approved, total credits may vary from other boards.

OHIO OCCUPATIONAL THERAPY, PHYSICAL THERAPY AND ATHLETIC TRAINERS BOARD (OTPTAT)

This course will be submitted for review to OTPTAT. No determination of creditworthiness has yet been made and, if approved, total credits may vary from other boards.

PENNSYLVANIA STATE BOARD OF PHYSICAL THERAPY (PAPT)

This course will be submitted for review to the Pennsylvania State Board of Physical Therapy. No determination of creditworthiness has yet been made and, if approved, total credits may vary from other boards.

TEXAS PHYSICAL THERAPY ASSOCIATION

This activity has been submitted for review to the Texas Physical Therapy Association. No determination of creditworthiness has yet been made and, if approved, total credits may vary from other boards.

States with reciprocity with Texas Physical Therapy Association: AL, AK, AZ, CT, DE, GA, HI, ID, IN, IA, KS, KY, LA, ME, MA, MI, MN, MO, MS, NE, NH, NC, ND, OR, RI, SC, SD, TN, UT, VT, VA, WA, WI, WY-updated 02/18

ACKNOWLEDGEMENTS

The Pediatric Research in Sports Medicine Society would like to thank the following organizations for their generous support of the Society and 9th Annual Meeting...



EXHIBITORS

We would like to thank the following companies for exhibiting at PRISM's 9th Annual Meeting. Exhibits are located in the Legends Pre-function area. These companies and organizations help to make our Annual Meeting possible, and we encourage you to visit the exhibits.



ANNOUNCEMENTS

CELL PHONES

As a courtesy to others, please silence your mobile devices during all presentations.

INTERNET ACCESS

Complimentary internet is available throughout the conference center and hotel.

MEALS

Breakfast and lunch will be provided on Friday, January 28th and Saturday, January 29th. Breakfast will be served in the Founders Ballroom and a grab and go lunch will be available in the Legends Pre-Function area.

NETWORKING RECEPTION- FRIDAY, JANUARY 28TH

A one-hour networking reception will be held throughout the conference space, including the Legends pre-function and the Champions balcony/pre-function (2nd floor) from 6:30-7:30pm. Participants will have a chance to speak with colleagues, exhibitors and poster presenters.

REGISTRATION DESK HOURS – LEGENDS PRE-FUNCTION

Wednesday, January 26 - 5:00pm-7:00pm

Thursday, January 27 – 6:30am-6:00pm

Friday, January 28 – 6:00am – 6:00pm

Saturday, January 29 – 6:30am – 12:00pm

OTHER MEETINGS*

	Date	Time	Room
SCORE	1/27/2022	7:00pm-9:00pm	Champions III
ROCK	1/27/2022	8:00am-12:00pm	Founders BR
BCH Reunion	1/28/2022	7:30pm-9:00pm	Champions I
Pluto	1/29/2022	7:00-8:00am	Champions VII

*Meetings are not affiliated with PRISM

MEETING ROOM PLANS

LOBBY LEVEL

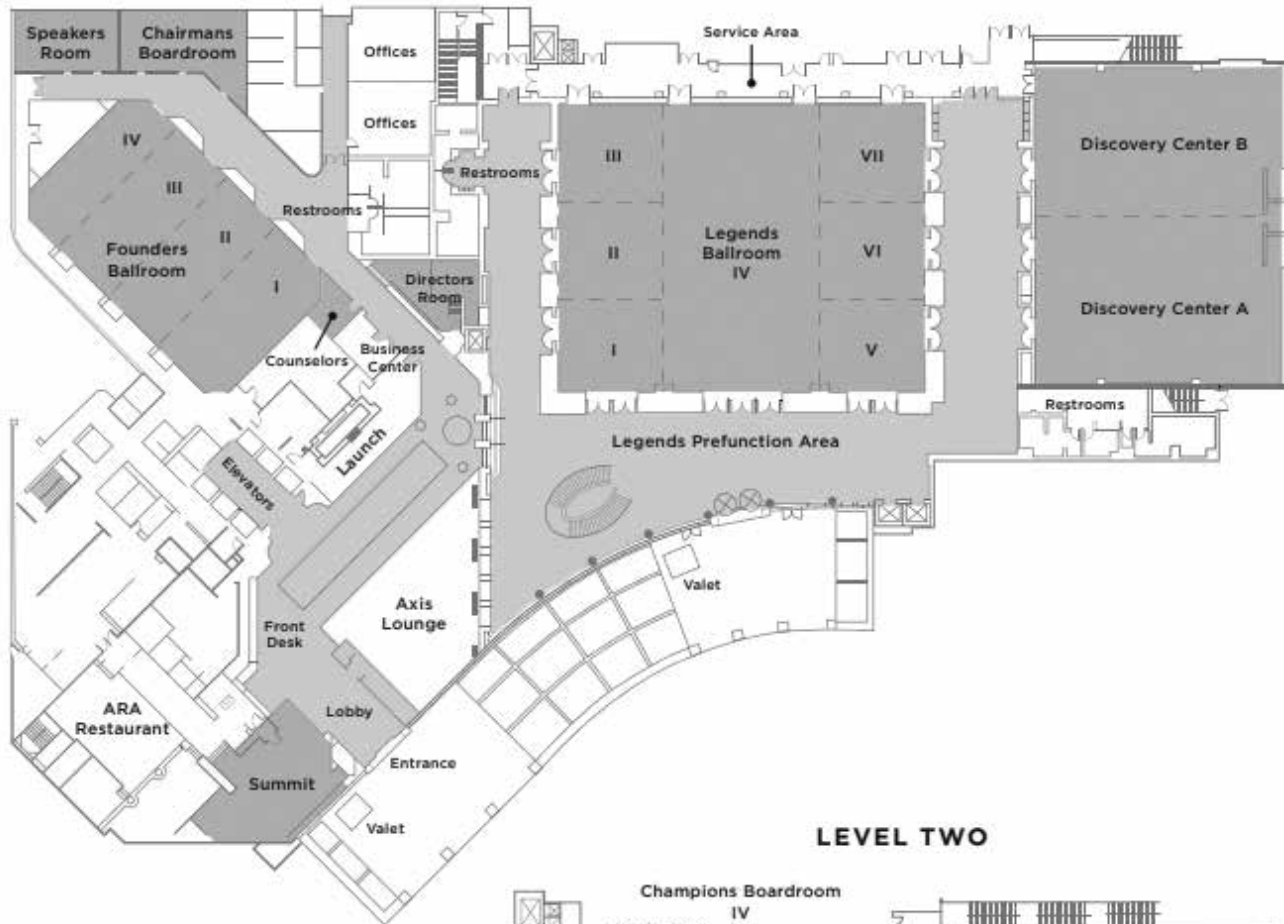

LEVEL TWO

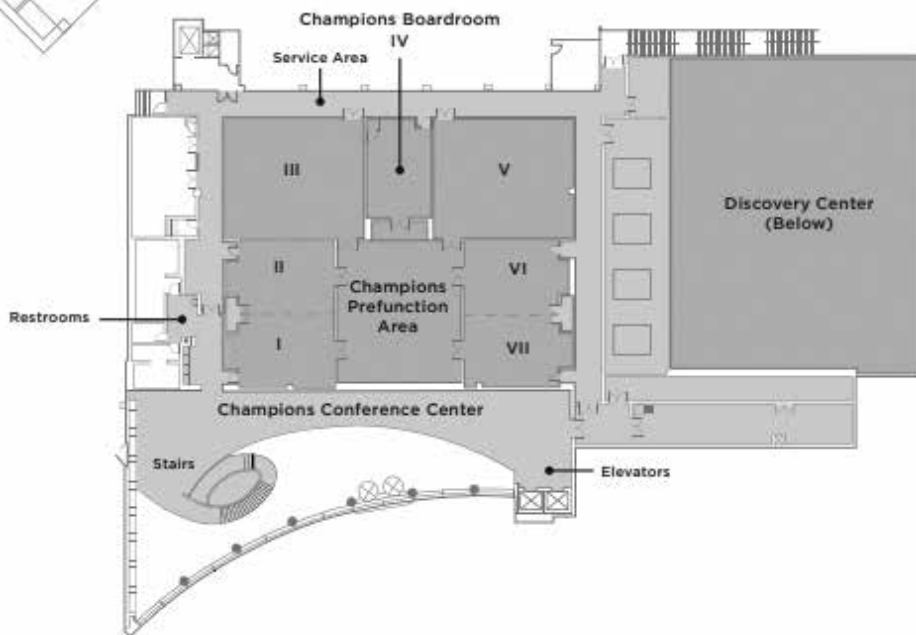

8:00 AM - 12:00 PM

Discovery A/B

PRE-COURSE: Youth Para Sports Medicine: An Interactive Course for All Pediatric Sports Medicine Clinicians

This 4-hour pre-course will focus on sports medicine topics related to the pediatric Para athlete and participation in Para sports. The course is intended for all pediatric sports medicine physicians, surgeons, therapists, and athletic trainers. The panel of faculty on this pre-course represent a diverse background of clinical practice and training all relevant to the practice of Para sports medicine across the country. The course will include a mixture of didactic lectures and break-out sessions with hands-on participation and skill training. Faculty presentations and break-out sessions include the history of Para sports, epidemiology, a discussion of health disparities involving sports participation, the benefits and importance of physical activity in those with disabilities, how to get youth with disabilities involved in Para sports, functional and technological assessments, surgical considerations, classification, sports injury and prevention, considerations for the team physician and sideline clinician of Para sports, demonstration of various Para sports and associated equipment or prosthetic evaluations and fitting, and discussion of future directions in Para sports, ending with a breakout to discuss collaborative research efforts.

Program Chair: *Stephanie Tow, MD*

Program Faculty: *Hank Chambers, MD, Jerry Clayton, PhD, Mary Dubon, MD, Jonathan Napolitano, MD, Amy Rabatin, MD, Jason Rhodes, MD, Carolina Schaber, RN, BSN, MBA, Stephanie Tow, MD, Pam Wilson, MD*

AGENDA

- 8:00 AM - 8:05 AM Introduction of Faculty
Stephanie Tow, MD
- 8:05 AM - 8:20 AM The Importance of Physical Activity and Sports Participation in Children and Adolescents with Disabilities
Jonathan Napolitano, MD
- 8:20 AM - 8:35 AM History of Para Sports
Jerry Clayton, PhD
- 8:35 AM - 8:50 AM AM Including Athletes of All Disabilities in Para Sports
Mark Fisher, MD
- 8:50 AM - 9:00 AM Break
- 9:00 AM - 9:30 AM Introduction to Classification in Paralympic Sports
Stephanie Tow, MD
- 9:30 AM - 10:15 AM Demonstration of Various Para Sports (Including Equipment and Classification Overview) and Prosthetics Evaluation/Fitting
- 10:15 AM - 10:25 AM Break
- 10:25 AM - 10:45 AM Common Injuries, Sideline Management, and Prevention in Para Athletes
Amy Rabatin, MD
- 10:45 AM - 11:05 AM Common Medical Issues, Sideline Management, and Prevention in Para Athletes
Mary Dubon, MD
- 11:05 AM - 11:35 AM Functional Assessments and Surgical Considerations in Para Sports
Hank Chambers, MD, Jason Rhodes, MD
- 11:35 AM - 12:00 PM Panel Discussion of Future Directions/Research in Para Sports Medicine
Moderator: Jonathan Napolitano, MD
Panelists: Hank Chambers, MD, Jerry Clayton, PhD, Jason Rhodes, MD, Stephanie Tow, MD, Pam Wilson, MD

12:30 - 1:30 PM

COMMITTEE MEETINGS

- Awards Champions I
- Communications Champions II
- Diversity Champions VI
- Education Champions V
- Membership Champions IV
- Research Champions III

2:00 - 2:10 PM

WELCOME

Matt Milewski, MD and Cordelia Carter, MD

Legends Ballroom

2:10 - 2:45 PM

ALLEN ANDERSON LECTURESHIP

PRISM: DID WE REALLY NEED ANOTHER ORGANIZATION?

Hank Chambers, MD

Legends Ballroom



Hank Chambers, MD is a pediatric orthopedic surgeon at Rady Children's Hospital in San Diego. He also serves as a Professor of Clinical Orthopedic Surgery at the University of California, San Diego. He graduated *summa cum laude* from the University of Colorado in 1978. After medical school at Tulane University School of Medicine, he completed an orthopedic surgery residency at Brooke Army Medical Center in San Antonio, TX. He finished a pediatric orthopedic surgery fellowship in San Diego under the tutelage of David Sutherland, Scott Mubarak and Dennis Wenger in 1990.

Dr. Chambers is currently the Director of the Southern Family Center for Cerebral Palsy Program at Rady Children's Hospital. He is also the Medical Director of the David H. Sutherland MD Motion Analysis Laboratory. He is a former co-director of the 360 Sports Medicine Program at Rady Children's Hospital. Hank was the Chief of Staff at Rady Children's Hospital San Diego from 2004-2006. He is active nationally in many organizations including the American Academy of Orthopedic Surgeons, the Pediatric Orthopedic Society of North America, and the American Academy of Pediatrics. He is a Past President of the American Academy for Cerebral Palsy and Developmental Medicine and is also the Past President of PRISM, a pediatric sports medicine research society which he co-founded. He has published over 120 publications and has authored over 30 book chapters. He has been fortunate to have been the Visiting Professor at over 100 institutions throughout the world and has been recognized as one of the Top Doctors in San Diego, Best Doctors in America, Top Doctors in the US News and World Report and Who's Who in America and in the World.

His wife, Jill, is active in many local and national patient advocacy groups and is a healing touch provider at Rady Children's Hospital. His son, Sean (39), who has cerebral palsy, is currently living independently (with support) in San Diego and his other son, Reid (38) is a pediatric orthopedic surgeon at Nationwide Children's Hospital in Columbus, OH.

2:45 - 3:45 PM

INSTRUCTIONAL COURSE 1: HOT OFF THE PRESS- TOP 5 IN 60

The field of pediatric sports medicine is changing at lightning speed and clinical research guides evidence-based practice. In 60 minutes, the panel will share with the audience the five hottest trends in pediatric sports medicine, the literature which supports them, and pearls for incorporating them into practice.

Crystal Perkins, MD, Cliff Willimon, MD, Henry Ellis, MD, Kevin Wilk, DPT

Legends Ballroom

3:45 - 4:00 PM

EXHIBIT AND POSTER VIEWING BREAK

4:00 - 4:45 PM

SCIENTIFIC PAPERS 1: ACL GENERAL

Legends Ballroom

- 4:00 - 4:02 PM Moderator: *Brendan Williams, MD*
- 4:02 - 4:07 PM Research Update & Literature Highlights - Injury Prevention RIG
Jo Janosky, DPHc, MS, PT, AT
- 4:07 - 4:12 PM BIOMARKERS OF KNEE JOINT HEALING IN ADOLESCENTS FOLLOWING ANTERIOR CRUCIATE LIGAMENT RECONSTRUCTION: A SYSTEMATIC REVIEW
Lisa Ek Orloff, MSc Student
- 4:12 - 4:17 PM PSYCHOLOGICAL READINESS TO RETURN TO SPORT AT 6 MONTHS IS HIGHER AFTER BRIDGE-ENHANCED ACL REPAIR THAN AUTOGRAFT ACL RECONSTRUCTION
Ryan M. Sanborn, BA
- 4:17 - 4:22 PM DELAYS IN ACL RECONSTRUCTION ARE ASSOCIATED WITH HIGHER RATES OF MENISCUS AND CHONDRAL PATHOLOGY IN SKELETALLY IMMATURE PATIENTS
Andrew Pennock, MD
- 4:22 - 4:27 PM CHANGE IN BODY WEIGHT AND BODY MASS INDEX OF ADOLESCENTS AND ADULTS FROM PRE-SURGERY TO POST-ANTERIOR CRUCIATE LIGAMENT RECONSTRUCTION
Ashley N. Triplett, PhD
- 4:27 - 4:32 PM DESCRIPTIVE EPIDEMIOLOGY OF COMPLETE ACL TEARS IN THE SKELETALLY IMMATURE POPULATION: A MULTICENTER INVESTIGATION OF THE PLUTO STUDY
Mininder S. Kocher, MD MPH
- 4:32 - 4:45 PM Discussion
Brendan Williams, MD

4:00 - 4:45 PM

SCIENTIFIC PAPERS 2: CONCUSSION 1

Discovery A/B

- 4:00 - 4:02 PM Moderator: *Tamara C. Valovich McLeod, PhD, ATC, FNATA*
- 4:02 - 4:07 PM Research Update & Literature Highlights- Concussion RIG
Shane Miller, MD
- 4:07 - 4:12 PM DIRECT COSTS OF CARE FOR ADOLESCENT PATIENTS WITH AND WITHOUT PERSISTING CONCUSSION SYMPTOMS IN UNITED STATES SECONDARY SCHOOLS: A REPORT FROM THE ATHLETIC TRAINING PRACTICE-BASED RESEARCH NETWORK
Tamara C. Valovich McLeod, PhD, ATC, FNATA
- 4:12 - 4:17 PM FINDINGS FROM THE PRISM CONCUSSION RIG: DOES THE 5P RISK SCORE PREDICT PERSISTENT POSTCONCUSSIVE SYMPTOMS IN A MULTI-CENTER SAMPLE OF YOUTH ATHLETES?
Shane M. Miller, MD
- 4:17 - 4:22 PM INJURY CHARACTERISTICS AMONG PEDIATRIC ATHLETES WHO DID AND DID NOT UNDERGO A CT SCAN FOLLOWING CONCUSSION
Jacob Jones, MD
- 4:22 - 4:27 PM HIGHER STUDENT CONFIDENCE IN THEIR SCHOOLS' ACADEMIC SUPPORT ASSOCIATED WITH LOWER ADVERSE ACADEMIC CONCERN FOLLOWING CONCUSSION
Mark Halstead, MD
- 4:27 - 4:32 PM DEMOGRAPHIC, INJURY CHARACTERISTICS, AND COMORBIDITY DIFFERENCES BETWEEN YOUTH WITH >28 DAY AND >90 DAY RECOVERY FROM CONCUSSION
Julie A. Young, ATC
- 4:32 - 4:45 PM Discussion
Tamara C. Valovich McLeod, PhD, ATC, FNATA

4:45 - 5:30 PM	<p>SCIENTIFIC PAPERS 3: KNEE</p> <p>4:45 - 4:47 PM Moderator: <i>Andy Pennock, MD</i></p> <p>4:47 - 4:52 PM Research Update & Literature Highlights - Bone Stress RIG <i>Emily Kraus, MD</i></p> <p>4:52 - 4:57 PM A MULTICENTER COMPARISON OF OPEN VERSUS ARTHROSCOPIC FIXATION FOR PEDIATRIC TIBIAL SPINE FRACTURES <i>Jilan L. Shimberg, BA</i></p> <p>4:57 - 5:02 PM NOVEL MRI CLASSIFICATION FOR OSTEOCHONDRITIS DISSECANS OF THE KNEE: A VALIDATION STUDY <i>Mininder S. Kocher, MD MPH</i></p> <p>5:02 - 5:07 PM MECHANICAL PROPERTIES OF PEDIATRIC KNEE LIGAMENTS AND THE ILIOTIBIAL BAND <i>M Sanchez, BS</i></p> <p>5:07 - 5:12 PM SUTURE-BRIDGE FIXATION OF OSTEOCHONDRAL FRACTURES AND OSTEOCHONRITIS DISSECANS IN THE ADOLESCENT KNEE: MIR ASSEMENT OF HEALING <i>Philip L. Wilson, MD</i></p> <p>5:12 - 5:17 PM EFFECTS OF A MEDIAL UNLOADER BRACE ON GAIT MECHANICS IN PATIENTS WITH OSTEOCHONDRITIS DISSECANS <i>Alex Loewen, MS</i></p> <p>5:17 - 5:30 PM Discussion <i>Andy Pennock, MD</i></p>	Legends Ballroom
4:45 - 5:30 PM	<p>SCIENTIFIC PAPERS 4: OUTCOME MEASURES</p> <p>4:45 - 4:47 PM Moderator: <i>Chuck Wyatt, MS, CPNP, RNFA</i></p> <p>4:47 - 4:52 PM Research Update & Literature Highlights - Sports Specialization RIG <i>Sophia Ulman, PhD</i></p> <p>4:52 - 4:57 PM SPORT-SPECIFIC AMCaMP: NEW MODULAR TOOLS FOR MEASURING ADOLESCENT SELF-CONFIDENCE IN SPORT-SPECIFIC MOVEMENT <i>Keith May, PT, DPT, SCS, ATC</i></p> <p>4:57 - 5:02 PM PATIENT REPORTED OUTCOME MEASURES IN PEDIATRIC ANTERIOR CRUCIATE LIGAMENT RECONSTRUCTION: DOES PROMIS CORRELATE WITH PEDI-IKDC? <i>Eric Pridgen, MD, PhD</i></p> <p>5:02 - 5:07 PM AN ACTIVITY SCALE FOR ALL YOUTH ATHLETES? AN ANALYSIS OF THE HSS PEDI-FABS IN 2274 PEDIATRIC SPORTS MEDICINE PATIENTS <i>Connor M. Carpenter, BBA</i></p> <p>5:07 - 5:12 PM NO DIFFERENCE IN PATIENT REPORTED OUTCOME MEASURES FOR PATIENTS WITH HIGH GRIT SCORES <i>Peter D. Fabricant, MD MPH</i></p> <p>5:12 - 5:17 PM DID THE COVID-19 PANDEMIC AFFECT PSYCHOLOGICAL READINESS TO RETURN-TO-SPORT IN YOUNG ATHLETES UNDERGOING ACL RECONSTRUCTION? <i>Matthew D. Milewski, MD</i></p> <p>5:17 - 5:30 PM Discussion <i>Chuck Wyatt, MS, CPNP, RNFA</i></p>	Discovery A/B
5:30 - 5:45 PM	<p>EXHIBIT AND POSTER VIEWING BREAK</p>	
5:45 - 7:00 PM	<p>COMPLEX CASES AND SPIRITED DEBATES</p> <p><i>Christina Master, MD</i></p>	Legends Ballroom

7:00 - 8:00 AM	BREAKFAST	Founders Ballroom
7:30 - 8:00 AM	PRISM BUSINESS MEETING	Legends Ballroom
8:00 - 9:00 AM	<p>INSTRUCTIONAL COURSE 2: CARE OF THE PEDIATRIC AND ADOLESCENT FEMALE ATHLETE</p> <p>During this course, the multidisciplinary approach from Primary Care Sports, Gynecology, Psychology, Nutrition and Physical Therapy will discuss establishing a health and wellness baseline and how that baseline impacts episodic care during injury and illness to optimize athletic outcomes. Emphasis will be directed at the impact of the menstrual cycle on athletic performance.</p> <p><i>Chimsom Oleka, MD, Elizabeth Victor Franklin, PhD, Sarah Dobkins, MS, RD, CSSD, LD, Jeffrey Shilt, MD, Emily Finanger, PT</i></p>	Legends Ballroom
9:00 - 9:45 AM	<p>SCIENTIFIC PAPERS 5- MENTAL HEALTH AND SLEEP</p> <p>9:00 - 9:02 AM Moderator: <i>TBD</i></p> <p>9:02 - 9:07 AM Research Update & Literature Highlights - Female Athlete RIG <i>Bianca Edison, MD MS FAAP</i></p> <p>9:07 - 9:12 AM THE IMPACT OF SPORT PARTICIPATION ON THE HEALTH OF ADOLESCENTS DURING THE COVID-19 PANDEMIC <i>Timothy A. McGuine, PhD ATC</i></p> <p>9:12 - 9:17 AM SLEEP PROBLEMS FOLLOWING CONCUSSION ARE ASSOCIATED WITH WORSE BALANCE AND MORE SEVERE SYMPTOMS IN YOUTH ATHLETES <i>Samantha N. Magliato, BS</i></p> <p>9:17 - 9:22 AM INFLUENCE OF ANXIETY SENSITIVITY AND NEGATIVE AFFECT ON CONCUSSION OUTCOMES <i>Todd Caze, II, PhD</i></p> <p>9:22 - 9:27 AM THE EFFICACY OF A MENTAL SKILLS TRAINING COURSE FOR COLLEGIATE ATHLETES <i>Kelsey L. Griffith, MS</i></p> <p>9:27 - 9:32 AM ASSESSMENT OF COPING SKILLS IN PEDIATRIC SPORTS MEDICINE PATIENTS <i>Melissa A. Christino, MD, FAAOS</i></p> <p>9:32 - 9:45 AM Discussion</p>	Legends Ballroom
9:45 - 10:30 AM	<p>BRINGING YOUR PASSION TO WORK: THE EVOLUTION OF A CAREER IN PARALYMPIC SPORTS MEDICINE</p> <p><i>Cheri Blauwet, MD</i></p> <div style="display: flex; align-items: flex-start;"> <div style="flex: 1;">  </div> <div style="flex: 2;"> <p>Cheri Blauwet, MD is an Assistant Professor in Physical Medicine and Rehabilitation at Harvard Medical School and the Distinguished Chair in Physical Medicine and Rehabilitation at Brigham Health. She is an attending physician at Mass General Brigham Sports Medicine and Founding Director of the Kelley Adaptive Sports Research Institute. Dr. Blauwet is also a former Paralympic athlete in the sport of wheelchair racing, competing for the United States Team in three Paralympic Games (Sydney '00, Athens '04, Beijing '08) and bringing home a total of seven Paralympic medals. She is also a two-time winner of both the Boston and New York City Marathons.</p> <p>Translating her background as an athlete to the clinical setting, Dr. Blauwet is a pioneer and change agent in the area of disability and health equity, with a specific focus on sport and physical activity for health promotion and chronic disease prevention. She is deeply committed to ensuring that opportunities for achieving optimal health are equitable and universally accessible to all, inclusive of people with disabilities. She serves as a Member of the International Paralympic Committee's Medical Committee and serves on the Board of Directors for the United States Olympic and Paralympic Committee (USOPC) as well as numerous other leadership roles throughout the Olympic and Paralympic Movement. In 2016, she was the recipient of the Harvard Medical School Harold Amos Faculty Diversity Award and was named one Boston's "Ten Outstanding Young Leaders" by the Greater Boston Chamber of Commerce. In 2019 she was named by the Boston Business Journal as one of the "40 under 40" community leaders.</p> </div> </div>	Legends Ballroom
10:30 - 10:45 AM	SPONSOR HIGHLIGHT: TEXAS CHILDREN'S HOSPITAL	
10:45 - 11:00 AM	POSTER AND EXHIBIT VIEWING BREAK	

FRIDAY, JANUARY 28

11:00 - 11:45 AM

SCIENTIFIC SESSION 6: MENISCUS

Legends Ballroom

- 11:00 - 11:02 AM Moderator: *Corinna Franklin, MD*
- 11:02 - 11:07 AM Research Update & Literature Highlights - Meniscus RIG
Jennifer Beck, MD
- 11:07 - 11:12 AM CLINICAL FEATURES AND OPERATIVE TREATMENTS OF DISCOID MEDIAL MENISCUS IN CHILDREN
Gregory A. Schmale, MD
- 11:12 - 11:17 AM ACCELERATED VS CONSERVATIVE REHABILITATION FOLLOWING MENISCUS REPAIR IN PEDIATRIC PATIENTS WITH OR WITHOUT ACL RECONSTRUCTION
Sabah B. Ali, BS
- 11:17 - 11:22 AM CAN THE DISCOID MENISCUS REMODEL AFTER SAUCERIZATION?
Charles M. Chan, MD
- 11:22 - 11:27 AM MENISCAL REPAIR OUTCOMES AT >5 YEARS: A SYSTEMATIC REVIEW AND META-ANALYSIS
Matt Eisenberg, BS
- 11:27 - 11:32 AM HIGHER RATES OF MENISCAL REPAIR AND RIM PRESERVATION IN YOUNGER PATIENTS WITH DISCOID LATERAL MENISCI
Scott D. McKay, MD
- 11:32 - 11:45 AM Discussion
Corinna Franklin, MD

11:00 - 11:45 AM

SCIENTIFIC SESSION 7: CONCUSSION 2

Discovery A/B

- 11:00 - 11:02 AM Moderator
Traci Snedden, PhD, RN, CPNP
- 11:02 - 11:07 AM Research Update & Literature Highlights - Spine RIG
Pierre d'Hemecourt, MD
- 11:07 - 11:12 AM AN 8-WEEK NEUROMUSCULAR TRAINING PROGRAM AFTER CONCUSSION REDUCES ONE-YEAR SUBSEQUENT INJURY RISK: A RANDOMIZED CLINICAL TRIAL
Julie C. Wilson, MD
- 11:12 - 11:17 AM QUANTIFYING HEAD IMPACT EXPOSURE, MECHANISMS AND KINEMATICS USING AN INSTRUMENTED MOUTHGUARD IN FEMALE HIGH SCHOOL LACROSSE
Colin M. Huber, BS
- 11:17 - 11:22 AM CONCUSSION PROFILE SCREEN OCULAR SUBTYPE SCORE AND OBJECTIVE FINDINGS OF OCULOMOTOR DYSFUNCTION IN PEDIATRIC CONCUSSION PATIENTS
Prem K. Thirunagari, BSHS, BS
- 11:22 - 11:27 AM IMPROVEMENT IN POSTURAL CONTROL FOLLOWING CONCUSSION IN ADOLESCENT ATHLETES: FROM CLINICAL PRESENTATION TO INITIATION OF RETURN TO PLAY
Sophia Ulman, PhD
- 11:27 - 11:32 AM ACCOMMODATIVE AMPLITUDE BEFORE AND AFTER EXERCISE AMONG ADOLESCENTS WITH SPORT-RELATED CONCUSSION
Eileen P. Storey, MD
- 11:32 - 11:45 AM Discussion
Traci Snedden, PhD, RN, CPNP

11:45 AM - 1:00 PM

Lunch

11:55 AM - 12:55 PM

RIG Meetings 1 (working lunch)

- Motion Analysis Champion III
- Injury Prevention Champion V
- Patellofemoral Instability Champion II
- Bone Stress Injury Champion I
- Knee Champion IV
- Meniscus Champion VI
- Spine/Spondy Champion VII
- Elbow Chairmans Boardroom

FRIDAY, JANUARY 28

1:00 – 2:00 PM

INSTRUCTIONAL COURSE 3: A MULTI-DISCIPLINARY APPROACH TO PSYCHOLOGICAL READINESS AND RETURN TO SPORT FOLLOWING ANTERIOR CRUCIATE LIGAMENT RECONSTRUCTION

Legends Ballroom

In recent years much of orthopaedic research regarding anterior cruciate ligament reconstruction has focused on exploring and perfecting surgical techniques. Although, despite consistent positive surgical outcomes many patients still never return to sport solely due to a lack of psychological readiness. This is why it is so critical for clinicians to identify at-risk patients early on post-operatively and in the rehabilitation process. It is important to collaborate and work as a multi-disciplinary team in order for the patients to successfully return to sport. We feel that the appropriate care team includes but is not limited to: the surgeon, sports psychologist, physical therapist, and athletic trainer. We plan to explore the roles and responsibilities of each team member as well as identify specific coping strategies that each member can utilize when helping to return a patient to sport.

Paul Saluan, MD, Gary Calabrese, DPT, PT, Kelsey Everhart, MS, ATC, Matthew Sacco, PhD, Tom Iannetta, ATC, CSCS, Manny Economos, ATC

1:00 - 2:00 PM

INSTRUCTIONAL COURSE 4: CARING FOR UNIQUE POPULATIONS IN PEDIATRIC SPORTS MEDICINE

Discovery A/B

This course focuses on the care of populations of athletes who have particular needs and vulnerabilities, including trans, para, and very young athletes. Racism and sexual abuse in pediatric sports medicine will also be discussed, and tools will be provided to combat these pervasive and devastating issues. Athletic identity and its impact on young athletes will also be explored.

Corinna Franklin, MD, Cordelia Carter, MD, Katherine Rizzone, MD, Kyle Nagle, MD, Melissa Christino, MD, Andrew Watson, MD

1:00 – 2:00 PM

INSTRUCTIONAL COURSE 5: POSTERIOR ANKLE IMPINGEMENT IN PEDIATRIC POPULATION: DIAGNOSIS AND MANAGEMENT

Founders Ballroom

Posterior ankle impingement is a well-known diagnosis in the adult literature however there is not much focus or literature on this topic in the pediatric population. In the last 3 years, the faculty members for this proposed webinar have presented at multiple national orthopedic and radiology meetings regarding the delay in diagnosis and features causing delay in making this diagnosis in this population. They are also the authors of multiple publications based on the first and largest prospective study on posterior ankle impingement in the pediatric population. Diversity Statement Compliance – Our proposed Faculty shows representation across diverse racial backgrounds, specialty, disciplines, experience.

Indranil Kushare MD, Jorge Gomez, MD, Adam Saloom, DPT, Siddharth Jadhav, MD

2:15 - 3:00 PM

SCIENTIFIC SESSION 8: ACL SURGERY

Legends Ballroom

- 2:15 - 2:17 PM Moderator: *Kevin Shea, MD*
- 2:17 - 2:22 PM Research Update & Literature Highlights - Tibial Spine RIG
JR Cruz
- 2:22 - 2:27 PM CORRELATION OF TANNER STAGE AND HYPERMOBILITY WITH MENISCAL AND ARTICULAR CARTILAGE INJURY IN THE PLUTO COHORT
Joseph Gibian, MD
- 2:27 - 2:32 PM PHYSICIAN PREFERENCES ON SURGICAL TECHNIQUE AND GRAFT TYPE FOR ANTERIOR CRUCIATE LIGAMENT (ACL) RECONSTRUCTIONS FOR PEDIATRIC PATIENTS WITH ACL INJURIES
Corinna C. Franklin, MD
- 2:32 - 2:37 PM RATES OF INFECTION AFTER PEDIATRIC ACL RECONSTRUCTION: A MARKETSCAN DATABASE STUDY OF 44,501 PATIENTS
Matt Eisenberg, BS
- 2:37 - 3:00 PM Discussion
Kevin Shea, MD

2:15 – 3:00 PM	<p>SCIENTIFIC SESSION 9: CONCUSSION 3</p> <p>2:15 - 2:17 PM Moderator: <i>Matt Grady, MD</i></p> <p>2:17 - 2:22 PM Research Update & Literature Highlights - Elbow RIG <i>Donna Pacicca, MD</i></p> <p>2:22 - 2:27 PM CONCUSSION SUBTYPING IN PEDIATRIC PATIENTS WITH PERSISTENT POST CONCUSSIVE SYMPTOMS USING A NEW CONCUSSION CLINICAL PROFILE SCREEN TOOL (CP SCREEN) <i>Prem K. Thirunagari, BSHS, BS</i></p> <p>2:27 - 2:32 PM MANAGING CONCUSSION PATIENTS VIA TELEHEALTH SERVICES COMPARED TO IN-PERSON CLINIC VISITS <i>August M. Price, PsyD</i></p> <p>2:32 - 2:37 PM SELF-REPORTED AMNESIA FOLLOWING CONCUSSION PREDICTS GREATER DEFICITS IN QUALITY OF LIFE DOMAINS AMONG PEDIATRIC ATHLETES <i>Tamara C. Valovich McLeod, PhD, ATC, FNATA</i></p> <p>2:37 - 2:42 PM A FUNCTIONAL NEAR INFRARED SPECTROSCOPY INVESTIGATION OF THE PHYSIOLOGICAL UNDERPINNINGS OF VISUAL COGNITIVE WORKLOAD AFTER CONCUSSION <i>Christina L. Master, MD</i></p> <p>2:42 - 2:47 PM POST-CONCUSSION DIZZINESS SEVERITY PREDICTS DAILY STEP COUNT DURING RECOVERY AMONG ADOLESCENT ATHLETES <i>Katherine Smulligan, PT, DPT</i></p> <p>2:47 - 3:00 PM Discussion <i>Matt Grady, MD</i></p>	Discovery A/B
3:00 – 4:00 PM	<p>INSTRUCTIONAL COURSE 6: MENTAL HEALTH IN THE YOUNG ATHLETE: A MULTIDISCIPLINARY PERSPECTIVE</p> <p>The purpose of this course is to discuss the impact mental health plays in young athletes. Athletes have similar mental health concerns as non-athletes but also have unique circumstances which may exacerbate mental health disorders. Recent literature has discussed the importance of early identification of mental health issues in sport as this can affect injury recovery as well as overall wellbeing and performance of athletes. We will discuss the roles that different members of the sports medicine team can play in identifying and managing mental health conditions. In addition to understanding the signs and symptoms seen in certain mental health conditions, including over-training and burnout. We will review resources and techniques that sports medicine providers may use to foster discussion with their young athletes and their families, as well as, overcome common treatment barriers.</p> <p><i>Jonathan Santana, MD, Marian Abowd, MS, LAT, ATC, Kayla Panos, DPT, Elizabeth Franklin, PhD</i></p>	Discovery A/B
3:00 – 4:00 PM	<p>INSTRUCTIONAL COURSE 7: ALL, LET, ACL: ALPHABET SOUP OF THE ANTEROLATERAL KNEE</p> <p>Recently, there has been increased interest in the anterolateral structures of the knee. Debate persists about the relevant anatomy as well its biomechanical implications on knee stability. A number of surgical procedures, including anterolateral ligament reconstruction and lateral extra-articular tenodesis, have gained popularity in the setting of ACL reconstruction, but the optimal indications, techniques, and outcomes remain unclear. In this course, the faculty aim to provide an evidence-based discussion of pertinent anatomic, biomechanical, and clinical aspects of the anterolateral knee in the context of ACL injury.</p> <p><i>Neeraj Patel, MD, MPH, MBS, Theodore Ganley, MD, Mininder Kocher, MD, MPH, Stephanie Logterman, MD, Sophia Ulman, PhD, Laura Boucher, PhD, ATC</i></p>	Legends Ballroom
4:00 – 4:15 PM	<p>POSTER AND EXHIBIT VIEWING BREAK</p>	

FRIDAY, JANUARY 28

4:15 – 5:15 PM

SCIENTIFIC SESSION 10: PATELLOFEMORAL INSTABILITY

Legends Ballroom

- 4:15 - 4:17 PM Moderator
Nicole Friel, MD MS
- 4:17 - 4:22 PM Research Update & Literature Highlights - Patellofemoral Instability RIG
Beth E. Shubin Stein, MD
- 4:22 - 4:27 PM SURGICAL MANAGEMENT OF PATELLOFEMORAL INSTABILITY IN ADOLESCENTS WITH HIGH GRADE TROCHLEAR DYSPLASIA
Benjamin R. Wilson, MD
- 4:27 - 4:32 PM CHANGES IN PATELLOFEMORAL JOINT MORPHOLOGY DURING SKELETAL GROWTH AND MATURATION ARE NOT SEX-DEPENDENT
James A. Pruneski, BS
- 4:32 - 4:37 PM OSSEOUS AND CARTILAGINOUS TROCHLEAR MORPHOLOGY IN PEDIATRIC PATIENTS FROM 2 MONTHS TO 11 YEARS OF AGE: A DESCRIPTIVE ANALYSIS BASED ON COMPUTED TOMOGRAPHY SCANNING
Salvador Ayala, B.S.
- 4:37 - 4:42 PM TECHNIQUE VARIATION FOR MPFL RECONSTRUCTION IN SKELETALLY IMMATURE PATIENTS: DATA FROM THE JUPITER COHORT
Benton E. Heyworth, MD
- 4:42 - 4:47 PM ISOLATED LATERAL RELEASE IS INFERIOR TO MEDIAL PATELLOFEMORAL LIGAMENT RECONSTRUCTION FOR SURGICAL MANAGEMENT OF PATELLA INSTABILITY IN PEDIATRIC PATIENTS
Seth L. Sherman, MD
- 4:47 - 4:52 PM THE EFFECTS OF EARLY RANGE OF MOTION VERSUS IMMOBILIZATION FOLLOWING ACUTE FIRST-TIME LATERAL PATELLAR INSTABILITY EPISODE: RANDOMIZED CONTROL TRIAL
Nicholas K. Purcell, PT, DPT, SCS
- 4:52 - 5:15 PM Discussion
Nicole Friel, MD MS

4:15 – 5:15 PM

SCIENTIFIC SESSION 11: SPECIAL TOPICS

Discovery A/B

- 4:15 - 4:17 PM Moderator
Julie Johnson, PT, MPT, SCS, CSCS
- 4:17 - 4:22 PM Research Update & Literature Highlights - Motion Analysis RIG
Kirsten Tulchin Francis, PhD
- 4:22 - 4:27 PM RELIABILITY OF A QUALITATIVE MOVEMENT ASSESSMENT TOOL DURING A SINGLE LEG TRIPLE HOP
Eli C. Epstein, PT
- 4:27 - 4:32 PM SEX AND AGE COMPARISONS OF PEDIATRIC TRACK & FIELD HURDLE INJURIES
Jacob Jones, MD
- 4:32 - 4:37 PM ARE DIFFERENT AGED YOUTH SKIERS AND SNOWBOARDERS EXPERIENCING DIFFERENT INJURY PATTERNS?
Kyle C. Chesler, BS
- 4:37 - 4:42 PM THE EFFECTS OF BLOOD FLOW RESTRICTION TRAINING ON STRENGTH AND FUNCTION DURING EARLY REHABILITATION AFTER ANTERIOR CRUCIATE LIGAMENT RECONSTRUCTION IN ADOLESCENTS
Nicholas G. Giampetruzzi, PT, MSPT
- 4:42 - 4:47 PM QUANTIFYING THE IMPACT OF THE COVID-19 PANDEMIC ON YOUTH SPORTS-RELATED INJURIES
Karina Oganezova, BS
- 4:47 - 4:52 PM INTER & INTRA TESTER RELIABILITY OF MOTION CAPTURE OF SIX SPORTS TASK USED FOR RETURN-TO-SPORT TESTING
Corinna C. Franklin, MD
- 4:52 - 5:15 PM Discussion
Julie Johnson, PT, MPT, SCS, CSCS

FRIDAY, JANUARY 28

5:15 – 6:15 PM	<p>INSTRUCTIONAL COURSE 8: SURGICAL TREATMENT OF PATELLOFEMORAL INSTABILITY RISK FACTORS IN SKELETALLY IMMATURE ATHLETE</p> <p>This course is intended to educate the PRISM audience about patellofemoral instability risk factors. The course will be case-based and the goal is to present examples of the many risk factors that must be evaluated in patellofemoral instability. The focus will be on indications and treatment options for these risk factors in skeletally immature athletes.</p> <p><i>Mark Tompkins, MD, Lauren Redler, MD, Lee Pace, MD, Melissa Christino, MD, FAAOS, Henry Ellis, MD, Dan Green, MD</i></p>	Legends Ballroom
5:15 – 6:15 PM	<p>INSTRUCTIONAL COURSE 9: MANUAL THERAPY FOR THE PEDIATRIC ATHLETE</p> <p>This course will present the most recent evidence for utilizing manual therapy as part of treatment for common conditions in the pediatric athlete. There are several diagnoses where best practice for athletic trainers and physical therapists includes using a variety of manual therapy techniques such as mobilization, manipulation, stretching, contract/relax, and soft tissue mobilization in order to resolve pain or stiffness. As a multidisciplinary team, our goal is to present this topic in a way so that all providers will better understand the mechanisms behind the effects of manual therapy. There are specific considerations when performing manual therapy in the pediatric athlete during different phases of development but the consequences of not resolving tissue stiffness in these patients may be significant. The audience will leave this course with practical, evidenced-based ways to improve their prescription of manual therapy whether they are providing the treatment or discussing the treatment with a physical therapist or athletic trainer.</p> <p><i>Nick Purcell PT, DPT, SCS, Scott McKay, MD, Joe Chorley, MD, Kari Lindegren, PT, DPT, OCS, Nicole Melfi, PT, DPT, ATC, SCS, John Schlechter, MD</i></p>	Discovery A/B
6:30 - 7:30 PM	<p>NETWORKING RECEPTION</p>	Pre-functions

FRIDAY, JANUARY 28

7:00 - 8:00 AM	BREAKFAST	Founders Ballroom
7:15 - 7:45 AM	STUDENT AND APP NETWORKING	Founders Ballroom
8:00 - 9:00 AM	<p>INSTRUCTIONAL COURSE 10: ADDRESSING DISPARITIES IN PEDIATRIC SPORTS MEDICINE</p> <p>Disparities in regards to care received and outcomes of intervention are present amongst pediatric and adolescent patients who presents with sports medicine injuries. Recognition of these disparities is critical amongst the multiple providers who care for the pediatric and adolescent athlete. Although not all encompassing, significant disparities exist base on race/ ethnicity, gender, and socio-economic status. An understanding of how these disparities present in the life cycle of care of the pediatric athlete are critical during all aspects of care.</p> <p><i>Nirav Pandya, MD, Cordelia Carter, MD, Jennifer Beck, MD, Neeraj Patel, MD, MPH, MBS, Julia Drattell, ATC, Bianca Edison, MD MS FAAP</i></p>	Legends Ballroom
9:00 - 9:30 AM	<p>GAVEL EXCHANGE AND AWARDS</p> <p><i>Matt Milewski, MD and Cordelia Carter, MD</i></p>	Legends Ballroom
9:30 - 10:15 AM	<p>SPORT, CULTURE, AND A NEED FOR A SOCIAL JUSTICE ORIENTATION</p> <p><i>Billy Hawkins, PhD</i></p>	Legends Ballroom



Dr. Hawkins is a professor at the University of Houston in the department of Health and Human Performance. He is the author of *The New Plantation: Black Athletes, College Sports, and Predominantly White NCAA Institutions*; and co-author of *Sport, Race, Activism, and Social Change: The Impact of Dr. Harry Edwards' Scholarship and Service, The Athletic Experience at Historically Black Colleges and Universities: Past, Present, and Persistence*, and the forthcoming *Critical Race Theory: Black Athletic Sporting Experiences in the United States*.

His teaching and research contributions are in the areas of sociology of sport and cultural studies, sport management, and sport for development. He has published in several peer-reviewed journals, as well as, presented to learned societies in the area of sport studies (including sport management, sport history, and sport sociology). He received his Ph.D. from the University of Iowa in Sport and Cultural Studies; a Master's of Science Degree in Human Performance from the University of Wisconsin at La Crosse, and a Bachelor of Science in Business Administration from Webber International University.

SATURDAY, JANUARY 29

10:15 - 10:30 AM

EXHIBIT AND POSTER VIEWING BREAK

10:30 - 11:30 AM

SCIENTIFIC SESSION 12: TOP POSTERS

Legends Ballroom

- 10:30 - 10:32 AM Moderator
Nicole Melfi, DPT, ATC, SCS
- 10:32 - 10:37 AM Research Update & Literature Highlights - Ultrasound RIG
Laura Boucher, MD
- 10:37 - 10:40 AM PREDICTORS OF RE-OPERATION IN ADOLESCENTS UNDERGOING HIP PRESERVATION SURGERY FOR FEMOROACETABULAR IMPINGEMENT
Philip A. Serbin, MD
- 10:40 - 10:43 AM THE EFFECT OF A HOME EXERCISE PROGRAM ON VISIO-VESTIBULAR FUNCTION IN CONCUSSED PEDIATRIC PATIENTS
Patricia R. Roby, PhD, ATC
- 10:43 - 10:46 AM PRE-PUBERTAL RUNNERS DEMONSTRATE DIFFERENT TEMPORAL-SPATIAL PARAMETERS THAN MID- AND POST-PUBERTAL RUNNERS
Micah C. Garcia, MS
- 10:46 - 10:49 AM SMARTPHONE MEASURED SINGLE- AND DUAL-TASK GAIT EVALUATION IN ADOLESCENTS POST-CONCUSSION: A LONGITUDINAL COMPARISON TO HEALTHY CONTROLS
Mathew J. Wingerson, BA
- 10:49 - 10:52 AM DOES SHORTENING CHANGE IN THE FIRST 3 WEEKS FOLLOWING COMPLETELY DISPLACED ADOLESCENT CLAVICLE FRACTURES?
Crystal Perkins, MD
- 10:52 - 10:55 AM THE IMPACT OF CONCOMITANT MENISCUS REPAIR ON FUNCTIONAL AND PATIENT REPORTED OUTCOMES AT RETURN TO ACTIVITY IN PAEDIATRIC PATIENTS UNDERGOING ACL RECONSTRUCTION
Sasha Carsen, MD
- 10:55 - 10:58 AM CHANGING TRENDS IN TREATMENT OF MENISCAL TEARS IN THE SETTING OF CONCOMITANT ACL TEAR IN PEDIATRIC AND ADOLESCENT PATIENTS: A MARKETSCAN INSURANCE DATABASE STUDY
Andrew Block, BS
- 10:58 - 11:02 AM RECOVERY FROM MEDIAL PATELLOFEMORAL LIGAMENT RECONSTRUCTION WITH AND WITHOUT TIBIAL TUBERCLE OSTEOTOMY: AN ASSESSMENT BY PROMIS
Andrew Block, BS
- 11:02 - 11:05 AM QUANTIFYING THE RELATIONSHIP BETWEEN THE MEDIAL PATELLOFEMORAL COMPLEX AND PATELLAR BORDERS: A PEDIATRIC CADAVERIC STUDY
Danika Baskar, BA
- 11:05 - 11:08 AM AN EXAMINATION OF YOUTH SPORT SPECIALIZATION PATTERNS AND PERCEPTIONS BETWEEN DEVELOPMENTAL STAGES AND COMPETITIVE CONTEXTS
Justin S. DiSanti, PhD
- 11:08 - 11:11 AM QUANTIFYING KNEE STRENGTH DEFICITS AND MUSCULAR CONTRIBUTION TO TORQUE GENERATION IN ACL-INJURED ADOLESCENTS USING A SIMPLE MUSCULOSKELETAL MODEL
Teresa E. Flaxman, MSc PhD
- 11:11 - 11:14 AM THE ASSOCIATION BETWEEN PHYSICAL COMPETENCE AND PSYCHOLOGICAL RESPONSE AMONG YOUNG ATHLETES FOLLOWING ACL RECONSTRUCTION
Christin M. Zwolski, PT, DPT, OCS
- 11:14 - 11:30 AM Discussion
Nicole Melfi, DPT, ATC, SCS

SATURDAY, JANUARY 29

11:30 AM - 1:00 PM	Lunch	
11:45 AM - 12:45 PM	RIG Meetings 2 (working lunch)	
	Hip Disorders	Chairmans Boardroom
	Tibial Spine	Champion III
	Sports Specialization	Champion VII
	Female Athlete	Champion I
	MSK Ultrasound	Champion IV
	Shoulder Instability	Champion II
	Concussion	Champion VI
	Rehabilitation	Champion V
1:00 – 2:00 PM	<p>INSTRUCTIONAL COURSE 11: UNDERSTANDING PATIENT PERCEPTIONS: CONSIDERING PSYCHOSOCIAL BARRIERS FOR RECOVERY IN PATIENTS WITH KNEE INJURY</p> <p>Physically active individuals often struggle with physical and psychosocial barriers to functional recovery following traumatic knee injury. However, psychosocial barriers are often overlooked during patient care. As healthcare providers, it is essential that we understand commonly overlooked psychosocial barriers to rehabilitation and return to physical activity after knee injury. Effective identification and implementation of rehabilitation strategies are necessary to overcome these barriers and maximize positive patient outcomes. This course will provide an overview of contextual evidence of common barriers to positive and negative rehabilitation experiences, and how they impact physical outcomes of recovery (e.g. failure to return to physical activity). Clinicians will learn how to identify the presence of injury-related fear and decreased confidence, which are two psychosocial barriers frequently observed in physically active populations after traumatic knee injury. Furthermore, clinicians will be able to identify strategies to overcome psychosocial barriers for recovery. The presentation is aimed at aiding clinicians in taking an evidence-based approach, including patient values, to rehabilitation and return to physical activity following knee injury.</p> <p><i>Christopher Kuenze, PhD, ATC, Shelby Baez, PhD, ATC</i></p>	Discovery A/B
1:00 – 2:00 PM	<p>INSTRUCTIONAL COURSE 12: CONTROVERSIES IN ADOLESCENT HIP PRESERVATION: PHYSICAL THERAPY VS. ARTHROSCOPIC VS. OPEN SURGICAL TREATMENT</p> <p>Hip problems in the adolescent are often first symptomatic during athletics. The optimal management of many conditions affecting the hip in young athletes remain controversial. For many conditions, treatment can include a spectrum from non-operative management/physical therapy to arthroscopic management to open surgical techniques. Which one is best? The focus of this PRISM ICL is to discuss a broad spectrum of conditions in the adolescent hip and the controversies in treating them. We will discuss indications for and when it is appropriate to use physical therapy or arthroscopic management vs open management. This panel discussion will be Evidence and Case-Based in attempt to help clarify best practices.</p> <p><i>Sasha Carsen, MD, Allison Crepeau, MD, Alfred Mansour, MD, Michelle Fearhellar, PT, DPT, Brian Haus, MD, Andrew Pennock, MD</i></p>	Legends Ballroom
1:00 – 2:00 PM	<p>INSTRUCTIONAL COURSE 13: MULTI-SPECIALTY COLLABORATIVE APPROACH TO POST-GRADUATE EDUCATION</p> <p>Post-graduate educational opportunities are continually increasing for a variety of health care professions. Although each profession has a specific role in the healthcare community, there are a variety of areas where healthcare providers can collaborate and gain knowledge from other disciplines to enhance their own practice and skill set. The goal of this presentation is to demonstrate how to meld components from a variety of post-graduate programs to benefit the future of all professionals involved.</p> <p><i>Nicole Melfi PT, DPT, SCS, ATC, Joe Chorley, MD, Valerie Parrish, PA-C, Erin Fernandez, ATC, LAT</i></p>	Founders Ballroom

SATURDAY, JANUARY 29

2:15 – 3:00 PM

SCIENTIFIC SESSION 13: LOWER EXTREMITY

Legends Ballroom

- 2:15 - 2:17 PM Moderator
Elliot Greenberg, PT, PhD
- 2:17 - 2:22 PM Research Update & Literature Highlights - Hip Disorder RIG
Sasha Carsen
- 2:22 - 2:27 PM FUNCTIONAL OUTCOMES OF ARTHROSCOPIC OS TRIGONUM EXCISION IN ADOLESCENTS
Liane Chun, MD
- 2:27 - 2:32 PM THE OUTCOMES OF CONSERVATIVE VERSUS SURGICAL TREATMENT OF PELVIC AND HIP AVULSION FRACTURES: A SYSTEMATIC REVIEW AND META-ANALYSIS
Andrew Block, BS
- 2:32 - 2:37 PM INCIDENCE AND RISK FACTORS OF HETEROTOPIC OSSIFICATION IN A MATCHED COHORT PEDIATRIC POPULATION UNDERGOING HIP ARTHROSCOPY
Yi-Meng Yen, MD PhD
- 2:37 - 2:42 PM SAGITTAL PLANE MOBILITY IN ADOLESCENTS WITH FEMOROACETABULAR IMPINGMENT
Benjamin Johnson, PA-C
- 2:42 - 2:47 PM MUSCULOSKELETAL ULTRASOUND OF THE PATELLAR TENDON IN ADOLESCENT ATHLETES
Laura C. Boucher, PhD, ATC
- 2:47 - 3:00 PM Discussion
Elliot Greenberg, PT, PhD

2:15 – 3:00 PM

SCIENTIFIC SESSION 14: PAIN/UPPER EXTREMITY

Discovery A/B

- 2:15 - 2:17 PM Moderator
Emily Sweeney, MD
- 2:17 - 2:22 PM Research Update & Literature Highlights - Shoulder Instability RIG
Jeremy Frank, MD
- 2:22 - 2:27 PM PATTERNS AND PREDICTORS OF OPIOID USE FOLLOWING SURGERY FOR SPORTS-INJURY IN ADOLESCENTS
Cornelius Groenewald, MD
- 2:27 - 2:32 PM VARIABILITY EXISTS IN PAIN MANAGEMENT PRACTICES FOR PEDIATRIC ACL RECONSTRUCTION
K. John Wagner, III, BS
- 2:32 - 2:37 PM ROTATOR CUFF INJURY IN THE PEDIATRIC POPULATION: A RETROSPECTIVE REVIEW OF PATIENT CHARACTERISTICS AND TREATMENT AT A SINGLE TREATMENT CENTER
Kathleen Harwood, BS
- 2:37 - 2:42 PM COMPARISON OF A NOVEL MRI TECHNIQUE THAT PRODUCES EQUIVALENT BONE CONTRAST WITH 2D-CT FOR THE ASSESSMENT OF GLENOID BONE LOSS
Joseph Chen, MD
- 2:42 - 2:47 PM SURGICAL MANAGEMENT OF DISTAL CLAVICLE FRACTURES IN SKELETALLY IMMATURE ATHLETES
Benton E. Heyworth, MD
- 2:47 - 3:00 PM Discussion
Emily Sweeney, MD

3:00 – 4:00 PM

SCIENTIFIC SESSION 15: ACL ANATOMY

Legends Ballroom

- 3:00 - 3:02 PM Moderator
Cordelia Carter, MD
- 3:02 - 3:07 PM Research Update & Literature Highlights - Knee Injury RIG
Matt Ellington, MD
- 3:07 - 3:12 PM CAN THE POSTERIOR CRUCIATE LIGAMENT (PCL) PREDICT ANTERIOR CRUCIATE LIGAMENT (ACL) SIZE FOR PLANNING DURING ACL RECONSTRUCTION?
Nicholas A. Strada, ScB
- 3:12 - 3:17 PM QUADRICEPS TENDON AUTOGRAFT IN PEDIATRIC ANTERIOR CRUCIATE LIGAMENT RECONSTRUCTION: GRAFT DIMENSIONS AND PREDICTION OF SIZE ON PREOPERATIVE MRI
Soroush Baghdadi, MD
- 3:17 - 3:22 PM DISTANCE TO NEUROVASCULAR BUNDLE DURING ILIOTIBIAL BAND ACL GRAFT PASSAGE: A CADAVERIC STUDY
Nicholas D. Thomas, MS
- 3:22 - 3:27 PM ACL GRAFT GROWTH IN PEDIATRIC PATIENTS AFTER ACL RECONSTRUCTION
Stephanie W. Mayer, MD
- 3:27 - 3:32 PM MORPHOLOGIC RISK FACTOR FOR ACL RUPTURE IN CHILDREN YOUNGER THAN AGE 12: AN MRI-BASED COMPARISON
Sarah Fogleman, MD
- 3:32 - 4:00 PM Discussion
Cordelia Carter, MD

3:00 – 4:00 PM

SCIENTIFIC SESSION 16: ACL REHAB

Discovery A/B

- 3:00 - 3:02 PM Moderator
Julie Dyke, DPT, SCS
- 3:02 - 3:07 PM Research Update & Literature Highlights - Rehab RIG
Michelle Feairheller, DPT, OCS, SCS, CSCS
- 3:07 - 3:12 PM A RETURN TO SPORT TEST BATTERY DOES NOT PREDICT SECOND INJURY AFTER ANTERIOR CRUCIATE LIGAMENT RECONSTRUCTION IN ADOLESCENT ATHLETES
Alexa Martinez, PT
- 3:12 - 3:17 PM DIFFERENCES IN THE COURSE OF REHABILITATION AND OUTCOMES FOR PUBLICLY INSURED PEDIATRIC PATIENTS AFTER ANTERIOR CRUCIATE LIGAMENT RECONSTRUCTION
Elliot Greenberg, PT, PhD
- 3:17 - 3:22 PM MONITORING RECOVERY AFTER PEDIATRIC ACL RECONSTRUCTION UTILIZING PROMIS
Andrew Block, BS
- 3:22 - 3:27 PM RELATIONSHIP BETWEEN ANKLE DORSIFLEXION MOBILITY AND FUNCTIONAL RETURN TO SPORT TEST PERFORMANCE IN ATHLETES WHO HAVE UNDERGONE ACL RECONSTRUCTION
Jessica Dabis, DPT
- 3:27 - 3:32 PM USING MACHINE LEARNING TO IDENTIFY THE OPTIMAL LIMB SYMMETRY INDEX CUT-OFF THRESHOLD IN PAEDIATRIC PATIENTS WITH ACL INJURY
Nicholas J. Romanchuk, MSc
- 3:32 - 3:37 PM FACTORS ASSOCIATED WITH STIFFNESS FOLLOWING PEDIATRIC AND ADOLESCENT ACL RECONSTRUCTION: EARLY RESULTS FROM SCORE: A MULTI-CENTER QUALITY IMPROVEMENT REGISTRY
Henry B. Ellis, Jr, MD
- 3:37 - 4:00 PM Discussion
Julie Dyke, DPT, SCS

SATURDAY, JANUARY 29

SCIENTIFIC POSTERS

Located throughout the conference space, including the Legends pre-function and the Champions balcony/pre-function (2nd floor). Presenting authors are underlined.

TOP 12		
P1	PREDICTORS OF RE-OPERATION IN ADOLESENTS UNDERGOING HIP PRESERVATION SURGERY FOR FEMOROACETABULAR IMPINGEMENT	<u>Philip A. Serbin, MD</u> ; <u>Savannah B. Cooper, MS</u> ; <u>Benjamin Johnson, PA-C</u> ; <u>Tyler Youngman, MD</u> ; <u>Philip L. Wilson, MD</u> ; <u>Dan Sucato, MD, MS</u> ; <u>David Podeszwa, MD</u> ; <u>Henry B. Ellis, Jr, MD</u>
P2	THE EFFECT OF A HOME EXERCISE PROGRAM ON VISIO-VESTIBULAR FUNCTION IN CONCUSSED PEDIATRIC PATIENTS	<u>Patricia R. Roby, PhD, ATC</u> ; <u>Eileen P. Storey, MD</u> ; <u>Christina L. Master, MD</u> ; <u>Kristy B. Arbogast, PhD</u>
P3	PRE-PUBERTAL RUNNERS DEMONSTRATE DIFFERENT TEMPORAL-SPATIAL PARAMETERS THAN MID- AND POST-PUBERTAL RUNNERS	<u>Micah C. Garcia, MS</u> ; <u>Emily A. Jordan, BS</u> ; <u>Brittany Vollmar, UG</u> ; <u>David M. Bazett-Jones, PhD, ATC, CSCS</u>
P4	SMARTPHONE MEASURED SINGLE- AND DUAL-TASK GAIT EVALUATION IN ADOLESCENTS POST-CONCUSSION: A LONGITUDINAL COMPARISON TO HEALTHY CONTROLS	<u>Mathew J. Wingerson, MS</u> ; <u>Corrine N. Seehusen, BA</u> ; <u>Julie C. Wilson, MD</u> ; <u>Katherine Smulligan, PT, DPT</u> ; <u>Robert C. Lynall, PhD, ATC</u> ; <u>Vipul Lugade, PhD</u> ; <u>David R. Howell, PhD</u>
P5	DOES SHORTENING CHANGE IN THE FIRST 3 WEEKS FOLLOWING COMPLETELY DISPLACED ADOLESCENT CLAVICLE FRACTURES?	<u>Crystal Perkins, MD</u> ; <u>Jeffrey J. Nepple, MD</u> ; <u>Joshua H. Pang, BA</u> ; <u>Elizabeth S. Liotta, MBBS</u> ; <u>Katelyn Hergott, MPH, MSW</u> ; <u>Benton E. Heyworth, MD</u>
P6	THE IMPACT OF CONCOMITANT MENISCUS REPAIR ON FUNCTIONAL AND PATIENT REPORTED OUTCOMES AT RETURN TO ACTIVITY IN PAEDIATRIC PATIENTS UNDERGOING ACL RECONSTRUCTION	<u>Sasha Carsen, MD</u> ; <u>Stijn Van Gennip, MD, MSc</u> ; <u>Nicholas J. Romanchuk, MSc</u> ; <u>Teresa E. Flaxman, MSc PhD</u> ; <u>Michael J. Del Bel, PhD(c)</u> ; <u>Ken Kontio, MD</u> ; <u>Daniel L. Benoit, PhD</u>
P7	CHANGING TRENDS IN TREATMENT OF MENISCAL TEARS IN THE SETTING OF CONCOMITANT ACL TEAR IN PEDIATRIC AND ADOLESCENT PATIENTS: A MARKETSCAN INSURANCE DATABASE STUDY	<u>Andrew Block, BS</u> ; <u>Matthew Eisenberg, MD</u> ; <u>Matthew L. Vopat, MD</u> ; <u>Jeffrey J. Nepple, MD</u>
P8	RECOVERY FROM MEDIAL PATELLOFEMORAL LIGAMENT RECONSTRUCTION WITH AND WITHOUT TIBIAL TUBERCLE OSTEOTOMY: AN ASSESSMENT BY PROMIS	<u>Andrew Block, BS</u> ; <u>Aravinda Ganapathy, BS</u> ; <u>Jeffrey J. Nepple, MD</u>
P9	QUANTIFYING THE RELATIONSHIP BETWEEN THE MEDIAL PATELLOFEMORAL COMPLEX AND PATELLAR BORDERS: A PEDIATRIC CADAVERIC STUDY	<u>Danika Baskar, BA</u> ; <u>Tyler J. Stavinoha, MD</u> ; <u>Matthew S. Rohde, BS</u> ; <u>Marc Tompkins, MD</u> ; <u>Theodore J. Ganley, MD</u> ; <u>Henry B. Ellis, Jr, MD</u> ; <u>Philip L. Wilson, MD</u> ; <u>Daniel W. Green, MD, MS, FACS</u> ; <u>Nicole A. Segovia, BS</u> ; <u>Kevin Shea, MD</u>
P10	AN EXAMINATION OF YOUTH SPORT SPECIALIZATION PATTERNS AND PERCEPTIONS BETWEEN DEVELOPMENTAL STAGES AND COMPETITIVE CONTEXTS	<u>Justin S. DiSanti, PhD</u> ; <u>Alison R. Snyder Valier, PhD, ATC</u> ; <u>Tamara C. Valovich McLeod, PhD, ATC, FNATA</u>
P11	QUANTIFYING KNEE STRENGTH DEFICITS AND MUSCULAR CONTRIBUTION TO TORQUE GENERATION IN ACL-INJURED ADOLESCENTS USING A SIMPLE MUSCULOSKELETAL MODEL	<u>Teresa E. Flaxman, MSc PhD</u> ; <u>Nicholas J. Romanchuk, MSc</u> ; <u>Mohammad S. Shourijeh, PhD</u> ; <u>Sasha Carsen, MD</u> ; <u>Michael J. Del Bel, PhD(c)</u> ; <u>Daniel L. Benoit, PhD</u>
P12	THE ASSOCIATION BETWEEN PHYSICAL COMPETENCE AND PSYCHOLOGICAL RESPONSE AMONG YOUNG ATHLETES FOLLOWING ACL RECONSTRUCTION	<u>Christin M. Zwolski, PT, DPT, OCS</u> ; <u>Mark V. Paterno, PT PhD MBA SCS ATC</u> ; <u>Staci Thomas; Brittany Hand, PhD, OTR/L</u> ; <u>Jackie Goodway, PhD</u> ; <u>Catherine C. Quatman-Yates, PT, PhD</u> ; <u>Laura C. Schmitt, PT, PhD</u>
ACL		
P13	PEDIATRIC LOW-GRADE ACL SPRAINS: TRENDS IN CHARACTERISTICS, MANAGEMENT, AND OUTCOMES	<u>Caitlyn E. Smith, BA</u> ; <u>Hannah M. Worrall, MPH, CCRP</u> ; <u>Henry B. Ellis, Jr, MD</u> ; <u>Philip L. Wilson, MD</u> ; <u>Jacob Jones, MD</u>
P14	ACL RECONSTRUCTION IN SKELETALLY IMMATURE PATIENTS: DOES GRAFT RETEAR AND COMPLICATION RATES DIFFER BASED ON SURGICAL TECHNIQUE? A SYSTEMATIC REVIEW	<u>Ryan P. Coene, MS</u> ; <u>Joshua H. Pang, BA</u> ; <u>Peter D. Fabricant, MD MPH</u> ; <u>Jeffrey J. Nepple, MD</u> ; <u>Matthew J. Matava, MD</u> ; <u>Benton E. Heyworth, MD</u>
P15	GRIT AFTER ACL RECONSTRUCTION: SEX DIFFERENCES AND ASSOCIATION WITH KNEE OUTCOMES AMONG ADOLESCENT ATHLETES	<u>Aubrey Armento, MD</u> ; <u>Stephanie L. Logterman, MD</u> ; <u>Alexia G. Gagliardi</u> ; <u>Whitney Hovater, BS</u> ; <u>David R. Howell, PhD</u> ; <u>Jay Albright, MD</u>
P16	"INFLUENCE OF GENDER, RACE/ETHNICITY & SOCIOECONOMIC FACTORS ON MENISCUS TREATMENT WITH PEDIATRIC AND ADOLESCENT ACL RECONSTRUCTION"	<u>Angela M. Mercurio, BS</u> ; <u>Ryan P. Coene, MS</u> ; <u>Danielle L. Cook, MA</u> ; <u>Lanna Feldman, MS</u> ; <u>Matthew D. Milewski, MD</u>
P17	OUTCOMES OF QUADRICEPS TENDON ANTERIOR CRUCIATE LIGAMENT RECONSTRUCTION IN SKELETALLY IMMATURE PATIENTS:2-YEAR FOLLOW-UP	<u>Sofia Hidalgo Perea, BS</u> ; <u>Frank A. Cordasco, MD</u> ; <u>Daniel W. Green, MD, MS, FACS</u>
P18	CAN A KNEE BRACE PREVENT ACL RE-INJURY: A SYSTEMATIC REVIEW	<u>Bianca Marois, MSc</u> ; <u>Xue Wei Tan</u> ; <u>Thierry Pauyo, MD, FRCSC</u> ; <u>Philippe Dodin, B.A., M.A., M.S.I</u> ; <u>Philippe Moisan, M.D</u> ; <u>Laurent Ballaz, PhD</u> ; <u>Marie-Lyne Nault, MD PhD</u>
P19	TRENDS IN ANTEROLATERAL LIGAMENT RECONSTRUCTION AND LATERAL EXTRA-ARTICULAR TENODESIS IN CHILDREN AND ADOLESCENTS	<u>Neeraj M. Patel, MD, MPH, MBS</u> ; <u>Scott D. McKay, MD</u> ; <u>Nirav K. Pandya, MD</u> ; <u>Theodore J. Ganley, MD</u>

SCIENTIFIC POSTERS

Located throughout the conference space, including the Legends pre-function and the Champions balcony/pre-function (2nd floor). Presenting authors are underlined.

P20	OLDER AGE AND SURGICAL DELAY MAY AFFECT MEDIAL MENISCUS REPAIRABILITY DURING ANTERIOR CRUCIATE LIGAMENT RECONSTRUCTION IN ADOLESCENTS AND YOUNG ADULTS	<u>Michael Saper, DO, ATC, CSCS</u> ; <u>Simran S. Mand, BS</u> ; <u>Woody Sorey, BA</u> ; <u>Chris Kweon, MD</u> ; <u>Albert Gee, MD</u> ; <u>Gregory A. Schmale, MD</u> ; <u>Viviana Bompadre, PhD</u> ; <u>Mia S. Hagen, MD</u>
P21	UNDERSTANDING THE PROGRESSION OF FUNCTION AND PSYCHOLOGICAL READINESS OF PRE-ADOLESCENT ATHLETES FOLLOWING ANTERIOR CRUCIATE LIGAMENT RECONSTRUCTION	<u>Elliot Greenberg, PT, PhD</u> ; <u>Julie Dyke, DPT, SCS</u> ; <u>Meredith Link, PT, ATC</u> ; <u>J. Todd Lawrence, MD PhD</u> ; <u>Theodore J. Ganley, MD</u>
P22	COMPARISON OF DYNAMIC LIMB VALGUS AND STIFF LANDING BETWEEN LIMBS WITH AND WITHOUT ANTERIOR CRUCIATE LIGAMENT RECONSTRUCTION	<u>Curtis VandenBerg, MD</u> ; <u>Mia J. Katzel, DPT</u> ; <u>Tishya A. L. Wren, PhD</u>
P23	ANTERIOR CRUCIATE LIGAMENT INJURIES CHANGE MUSCLE CO-ACTIVATION STRATEGIES IN ADOLESCENT FEMALES DURING LANDING	<u>Michael J. Del Bel, PhD(c)</u> ; <u>Nicholas J. Romanchuk, MSc</u> ; <u>Daniel L. Benoit, PhD</u> ; <u>Sasha Carsen, MD</u>
P24	A MODIFIED LEMAIRE LATERAL EXTRA-ARTICULAR TENODESIS IN HIGH RISK ADOLESCENTS UNDERGOING ANTERIOR CRUCIATE LIGAMENT RECONSTRUCTION: TWO-YEAR CLINICAL OUTCOMES	<u>Frank A. Cordasco, MD</u> ; <u>Sofia Hidalgo Perea, BS</u> ; <u>Christopher Brusalis</u> ; <u>Daniel W. Green, MD, MS, FACS</u>

CONCUSSION

P25	COMPARING ACADEMIC CHALLENGES AND QUALITY OF LIFE IN CONCUSSED ADOLESCENTS PRIOR TO AND DURING THE COVID-19 PANDEMIC	<u>Traci Snedden, PhD, RN, CPNP</u> ; <u>Tamara C. Valovich McLeod, PhD, ATC, FNATA</u> ; <u>Mark Halstead, MD</u> ; <u>Julie C. Wilson, MD</u> ; <u>Christinna Master, MD</u> ; <u>Matthew F. Grady, MD</u> ; <u>Matthew L. Fazekas, MD</u> ; <u>Jonathan A. Santana, DO</u> ; <u>Tracy Zaslow, MD FAAP CAQSM</u> ; <u>Shane M. Miller, MD</u> ; <u>David R. Howell, PhD</u>
P26	OBJECTIVE INFRARED EYE TRACKING AIDS IN THE IDENTIFICATION OF CONCUSSION-RELATED VISION DISORDERS IN ADOLESCENTS WITH PERSISTENT POST-CONCUSSIVE SYMPTOMS	<u>Christina L. Master, MD</u> ; <u>Tyson Rogers, MS</u> ; <u>Olivia E. Podolak, MD</u> ; <u>David R. Howell, PhD</u> ; <u>Matthew F. Grady, MD</u> ; <u>Mitchell Scheiman, OD, PhD</u>
P27	DIAGNOSTIC AND PREDICTIVE ABILITY OF REACTION TIME ASSESSMENTS FOR ADOLESCENT CONCUSSION	<u>Mathew J. Wingerson, MS</u> ; <u>Corrine N. Seehusen, BA</u> ; <u>Julie C. Wilson, MD</u> ; <u>Katherine Smulligan, PT, DPT</u> ; <u>Sarah E. Reinking, PT, DPT, SCS</u> ; <u>Samantha N. Magliato, BS</u> ; <u>David R. Howell, PhD</u>
P28	BURNOUT IN TEAM SPORT ATHLETES VS. INDIVIDUAL SPORT ATHLETES	<u>Scott Passalugo, Bachelor of Science</u> ; <u>Corey Lanois, MS, ATC</u> ; <u>William P. Meehan, MD</u> ; <u>David R. Howell, PhD</u>
P29	NON-PRIVATE HEALTH INSURANCE PLANS AND DELAYED ACCESS TO A SPECIALTY CONCUSSION CLINIC	<u>Christine S. Ellis, MSN</u>
P30	VISUAL FATIGUE AS A PREDICTOR OF EXERCISE TOLERANCE IN PEDIATRIC ATHLETES WITH CONCUSSION	<u>Matthew Bell, DO</u>
P31	PLURALISTIC IGNORANCE IN CONCUSSION REPORTING AMONG STUDENT-ATHLETES	<u>Paul Berkner, DO</u> ; <u>Haley Driscoll, BA</u> ; <u>Gregory Marchetti, PT, PhD</u> ; <u>Joseph W. Penna, BS</u> ; <u>Humza Ali, BS</u> ; <u>Danielle E. Jewell, BSN in Progress</u> ; <u>Lily Herrmann, BA</u>
P32	K-12 ATHLETIC TRAINERS' CURRENT CONCUSSION BASELINE PRACTICE PATTERNS	<u>Richelle M. Williams, PhD</u> ; <u>Nicholas Hattrup, MS, ATC</u> ; <u>Jamie Pardini, PhD</u> ; <u>Marla Shapiro, PhD, HSP, NCSP</u>
P33	PUPILLARY LIGHT REFLEX METRICS DIFFER IN ADOLESCENTS WITH ACUTE CONCUSSION VS. PERSISTENT POST-CONCUSSION SYMPTOMS	<u>Christina L. Master, MD</u> ; <u>Olivia E. Podolak, MD</u> ; <u>Kenneth Ciuffreda, OD, PhD</u> ; <u>Nabin Joshi, PhD</u> ; <u>Catherine McDonald, PD</u> ; <u>Susan S. Margulies, PhD</u> ; <u>Matthew Grady, MD</u> ; <u>Kristy B. Arbogast, PhD</u>
P34	EFFECT OF MENSTRUAL DYSFUNCTION IN ADOLESCENT CONCUSSION PATIENTS ON LENGTH OF TIME TO RECOVERY AND SYMPTOM BURDEN	<u>Brandon W. Barsky, MD</u> ; <u>Anastasia Fischer, MD, FAAFP, FACSM</u> ; <u>Julie A. Young, ATC</u>
P35	FEMALE COLLISION SPORT ATHLETES REPORT HIGHER SYMPTOM BURDEN AT BASELINE THAN CONTACT AND NON-CONTACT ATHLETES	<u>Jessie R. Oldham, PhD</u> ; <u>David R. Howell, PhD</u> ; <u>Corey Lanois, MS, ATC</u> ; <u>Paul Berkner, DO</u> ; <u>Rebekah C. Mannix, MD, MPH</u> ; <u>William P. Meehan, MD</u>

FEMALE ATHLETE

P36	THE ASSOCIATION BETWEEN THE FEMALE ATHLETE TRIAD AND MENTAL HEALTH IN HIGH SCHOOL ATHLETES	<u>Emily E. Wolfenden, MD, MPH</u> ; <u>Emily M. Olson, MD</u> ; <u>Shayna R. Mehta, BA</u> ; <u>Kristin Sainani, PhD</u> ; <u>Megan Deakins-Roche</u> ; <u>Karis Jochen, MS</u> ; <u>Katherine Hastings</u> ; <u>Emily Kraus, MD</u>
-----	--	---

FOOT/ANKLE

P37	ACHILLES TENDON TEARS IN ADOLESCENTS AND YOUNG ADULTS	<u>Dennis E. Kramer, MD</u> ; <u>Jennifer Beck, MD</u> ; <u>Ryan M. Sanborn, BA</u> ; <u>Patricia E. Miller, MS</u> ; <u>Yi-Meng Yen, MD PhD</u> ; <u>Howard Park</u> ; <u>Benton E. Heyworth, MD</u>
-----	---	---

HIP DISORDERS

P38	TREATMENT OF BORDERLINE ACETABULAR DYSPLASIA IN THE ADOLESCENT PATIENT: OUTCOMES OF PERIACETABULAR OSTEOTOMY	<u>Frank Parilla, MD</u> ; <u>John Clohisy</u> ; <u>Jeffrey J. Nepple, MD</u>
-----	--	---

SCIENTIFIC POSTERS

Located throughout the conference space, including the Legends pre-function and the Champions balcony/pre-function (2nd floor). Presenting authors are underlined.

MENISCUS		
P39	RELIABILITY OF MAGNETIC RESONANCE IMAGING INTERPRETATION OF LATERAL DISCOID MENISCUS: A MULTICENTER STUDY	<u>Emily Niu, MD</u> ; <u>Matthew D. Milewski, MD</u> ; <u>Craig J. Finlayson, MD</u> ; <u>Zachary S. Stinson, MD</u> ; <u>Elaine Joughin, MD FRCSC</u> ; <u>Jeffrey J. Nepple, MD</u> ; <u>Gregory A. Schmale, MD</u> ; <u>Jennifer Beck, MD</u>
P40	PLAIN RADIOGRAPHS HAVE LIMITED UTILITY IN THE EVALUATION OF DISCOID LATERAL MENISCUS	<u>Reid P. Schlesinger, BS</u> ; <u>Sean M. Rangwani, BS</u> ; <u>Neeraj M. Patel, MD, MPH, MBS</u>
P41	MAGNETIC RESONANCE IMAGE (MRI) MEASUREMENTS OF LATERAL DISCOID MENISCUS (LDM) IN PEDIATRIC PATIENTS MATCH ADULT LATERAL DISCOID MENISCUS DEFINITIONS	<u>Jennifer Beck, MD</u> ; <u>Anna Wood, BS</u> ; <u>Abbie Bennett, M.S.</u> ; <u>Nicholas J. Jackson, PhD</u>
P42	LONG-TERM MINIMUM 15-YEAR FOLLOW UP AFTER LATERAL DISCOID MENISCAL PRESERVATION SURGERY IN CHILDREN AND ADOLESCENTS	<u>Laura A.B. Lins, MD, MPH, ATC</u> ; <u>Aliya G. Feroe, MPH</u> ; <u>Brian Yang, MD</u> ; <u>Kathryn Williams, MS</u> ; <u>Sophia D. Kocher, -</u> ; <u>Saritha Sankarankutty, MBBS, MPH</u> ; <u>Lyle J. Micheli, MD</u> ; <u>Mininder S. Kocher, MD, MPH</u>
MOTION ANALYSIS		
P43	DIFFERENCES IN LOWER EXTREMITY KINEMATICS BASED ON DROP VERTICAL JUMP TASK VARIATIONS	<u>Alex Loewen, MS</u> ; <u>Ashley Erdman, BS, MBA</u> ; <u>Kirsten Tulchin-Francis, PhD</u> ; <u>Sophia Ulman, PhD</u>
P44	ALTERED JOINT POWERS DURING RUNNING AFTER TIBIAL BONE STRESS INJURY	<u>Samuel M. Lyons, M.S.</u>
CLAVICLE		
P45	REMODELING OF ADOLESCENT DISPLACED CLAVICLE FRACTURES: A FACTS STUDY	<u>Andrew Pennock, MD</u> ; <u>Donald Bae, MD</u> ; <u>Kelly Boutelle, BS</u> ; <u>Michael Busch, MD</u> ; <u>Alyssa N. Carroll, BS</u> ; <u>Eric W. Edmonds, MD, FAOA</u> ; <u>Henry B. Ellis, Jr., MD</u> ; <u>Katelyn Hergott, MPH, MSW</u> ; <u>Mininder S. Kocher, MD MPH</u> ; <u>Ying Li, MD</u> ; <u>Jeffrey J. Nepple, MD</u> ; <u>Nirav K. Pandya, MD</u> ; <u>Crystal Perkins, MD</u> ; <u>Coleen Sabatini, MD</u> ; <u>David D. Spence, MD</u>
CLAVICLE FRACTURES		
P46	SHORT-TERM RECOVERY AFTER DISPLACED ADOLESCENT CLAVICLE FRACTURES: DO DIFFERENCES IN EXIST BETWEEN SURGICAL AND NON-SURGICAL TREATMENTS?	<u>Andrew Block, BS</u> ; <u>Aravinda Ganapathy, BS</u> ; <u>Jeffrey J. Nepple, MD</u>
COVID-19 EFFECTS ON SPORT		
P47	SPORTS AND PHYSICAL ACTIVITY ATTENUATE THE EMOTIONAL TOLL OF THE COVID-19 PANDEMIC.	<u>Gregory A. Walker, MD, FAAP, CAQSM</u> ; <u>Corrine N. Seehusen, BA</u> ; <u>Aubrey Armento, MD</u> ; <u>Aaron Provance, MD</u> ; <u>David R. Howell, PhD</u>
GENERAL - PANDEMIC-RELATED		
P48	THE EFFECTS OF THE COVID-19 PANDEMIC ON PEDIATRIC ORTHOPAEDIC SPORTS MEDICINE & ARTHROSCOPY: PRACTICE IMPLICATIONS, AND THE MANAGEMENT AND TRIAGING OF SURGICAL CASES	<u>Sasha Carsen, MD</u> ; <u>Aristides I. Cruz, Jr., MD, MBA</u> ; <u>Henry B. Ellis, Jr., MD</u> ; <u>Curtis VandenBerg, MD</u> ; <u>Stephanie W. Mayer, MD</u> ; <u>Emily Niu, MD</u> ; <u>Jennifer Beck, MD</u>
INJURY EPIDEMIOLOGY		
P49	PEDIATRIC HURDLE INJURIES IN TRACK AND FIELD: A DESCRIPTIVE EPIDEMIOLOGIC STUDY	<u>Luke C. Radel, MD</u> ; <u>Jacob Jones, MD</u> ; <u>Kyle Garcia, MD</u> ; <u>David B. Soma, MD</u> ; <u>Dai Sugimoto, PhD, ATC</u>
KNEE SURGERY COMPLICATIONS		
P50	REGULATION AND SELECTIVE UTILIZATION OF PERIPHERAL NERVE BLOCKS DECREASE RESIDUAL NEUROLOGICAL SYMPTOMS AFTER PEDIATRIC KNEE SURGERY	<u>Amy L. Xu, BS</u> ; <u>R. Jay Lee, MD</u>
PCL		
P51	AGE-RELATED CHANGES ON MRI OF POSTERIOR CRUCIATE LIGAMENT MORPHOLOGY IN A SKELETALLY IMMATURE POPULATION	<u>Rachel A. Flaugh, BS</u> ; <u>Aliya G. Feroe, MPH</u> ; <u>Amir A. Shahein, MD</u> ; <u>Stephen Mathew, MD</u> ; <u>Patricia E. Miller, MS</u> ; <u>Mininder S. Kocher, MD, MPH</u>
PEDIATRIC SPORTS MEDICINE PRACTICE		
P52	VARIABLE PRACTICE PATTERNS AND VARIATION AMONG ORTHOPAEDIC SURGEONS SPECIALIZING IN PEDIATRIC SPORTS MEDICINE	<u>Andrew Block, BS</u> ; <u>Henry B. Ellis, Jr., MD</u> ; <u>Matthew R. Schmitz, MD</u> ; <u>Allison Crepeau, MD</u> ; <u>Hip RIG, MD</u> ; <u>Jeffrey J. Nepple, MD</u>

SCIENTIFIC POSTERS

Located throughout the conference space, including the Legends pre-function and the Champions balcony/pre-function (2nd floor). Presenting authors are underlined.

PROXIMAL HUMERUS FRACTURES		
P53	FACTORS INFLUENCING OPERATIVE MANAGEMENT OF ADOLESCENT PROXIMAL HUMERUS FRACTURES	<u>Jason Chan, MD</u> ; <u>Ashok Para, MD</u> ; <u>Vanessa Hernandez, BS</u> ; <u>Sarah Nagel, BS</u> ; <u>Lindsay M. Crawford, MD</u> ; <u>Sekinat K. McCormick, MD</u> ; <u>Flo Edobor-Osula, MD, MPH</u>
SINDING-LARSEN-JOHANSSON DISEASE		
P54	SINDING-LARSEN-JOHANSSON DISEASE: ANALYSIS OF THE ASSOCIATED FACTORS IN THE LARGEST COHORT TO DATE	<u>Kyle L. McCormick, MD</u> ; <u>Liana J. Tedesco, MD</u> ; <u>Elise Bixby, MD</u> ; <u>Hasani W. Swindell, MD</u> ; <u>Charles A. Popkin, MD</u> ; <u>Lauren H. Redler, MD</u>
SURGERY		
P55	ELECTIVE SPORTS SURGERY LEADS TO POSTOPERATIVE WEIGHT CHANGES IN PEDIATRIC PATIENTS	<u>Sharon G. Huang, BA</u> ; <u>Henry B. Ellis, Jr, MD</u> ; <u>Hannah M. Worrall, MPH, CCRP</u> ; <u>Brandon A. Ramo, MD</u> ; <u>Philip L. Wilson, MD</u>
WOUND HEALING, KNEE SURGERY, YOUTH ATHLETES		
P56	WOUND DILEMMAS: INVESTIGATING THE EFFECT OF BARBED KNOTLESS SUTURE VERSUS SMOOTH SUTURE FOR SUBCUTICULAR TISSUE CLOSURE DURING KNEE SURGERY IN YOUTH ATHLETES	<u>Henry Tsang, DO</u> ; <u>Bryn Gornick, BS</u> ; <u>John A. Schlechter, DO</u>
OUTCOME MEASURES		
P57	ESTABLISHING A CROSSTALK BETWEEN PEDIATRIC AND ADULT PROMIS DOMAINS IN SPORTS MEDICINE	<u>Andrew Block, BS</u> ; <u>Arya Minaie, BS</u> ; <u>Meghan Merklain, MD</u> ; <u>Jeffrey J. Nepple, MD</u>
PARALYMPIC		
P58	COVID-19 RESTRICTIONS AND THE EFFECTS OF PHYSICAL ACTIVITY ON MENTAL HEALTH IN MIDWESTERN ADOLESCENT ADAPTIVE ATHLETES	<u>Joshua Choe, MS</u> ; <u>Saji Azerf, MD</u> ; <u>Pamela Lang, MD</u>
PATELLOFEMORAL INSTABILITY		
P59	RADIOLOGIC PREDICTORS OF FAILURE OF PATELLOFEMORAL INSTABILITY SURGERY IN ADOLESCENTS	<u>Benjamin R. Wilson, MD</u> ; <u>Evan T. Zheng, BA</u> ; <u>Danielle L. Cook, MA</u> ; <u>Zaamin Hussain, MD</u> ; <u>Kianna D. Nunally, BA</u> ; <u>Benton E. Heyworth, MD</u> ; <u>Lyle J. Micheli, MD</u> ; <u>Yi-Meng Yen, MD PhD</u> ; <u>Dennis E. Kramer, MD</u> ; <u>Mininder S. Kocher, MD MPH</u>
P60	OUTCOMES OF ISOLATED MEDIAL PATELLOFEMORAL LIGAMENT RECONSTRUCTION FOR RECURRENT PATELLAR INSTABILITY IN EHLERS-DANLOS SYNDROME	<u>James Nemunaitis, DO</u> ; <u>Shital N. Parikh, MD</u>
P61	RETURN TO PLAY RATES OF YOUNG ATHLETES AFTER PATELLOFEMORAL INSTABILITY TREATMENT	<u>Madison Brenner, BSA</u> ; <u>Savannah B. Cooper, MS</u> ; <u>Benjamin Johnson, MPAS, PA-C</u> ; <u>Charles Wyatt, MS, CPNP</u> ; <u>Philip Wilson, MD</u> ; <u>Henry Ellis, MD</u>
P62	TROCHLEOPLASTY IN THE PEDIATRIC POPULATION - A SYSTEMATIC REVIEW OF PATIENT CHARACTERISTICS, TREATMENT STRATEGIES AND OUTCOMES	<u>Chad Amato, MD</u> ; <u>Brendan A. Williams, MD</u>
REHABILITATION		
P63	PATIENT, PARENT, AND PHYSICAL THERAPIST PERCEPTIONS OF REHABILITATION FOLLOWING ACL RECONSTRUCTION: A MULTIPLE STAKEHOLDER QUALITATIVE STUDY	<u>Chris Kuenze, PhD, ATC</u> ; <u>Jordan Lewis, BS</u> ; <u>Nate Farner, BS</u> ; <u>Caroline Lisee, PhD</u> ; <u>Andrew Schorfhaar, DO</u> ; <u>Karl Erickson, PhD</u>
P64	PHYSICAL THERAPY VISIT UTILIZATION IS NOT ASSOCIATED WITH HOP TEST PERFORMANCE AFTER ACL RECONSTRUCTION IN PEDIATRIC AND ADOLESCENT ATHLETES: A MULTICENTER STUDY	<u>Michael Saper, DO, ATC, CSCS</u> ; <u>Lauren Butler, PT, DPT, SCS</u> ; <u>Nicholas G. Giampetruzzi, PT, MSPT</u> ; <u>Elliot Greenberg, PT, PhD</u> ; <u>Meredith Link, PT, ATC</u> ; <u>Victor V. Prati, PT</u> ; <u>Adam P. Weaver, PT, DPT</u>
SHOULDER INSTABILITY		
P65	OBJECTIVE DIAGNOSIS OF MULTIDIRECTIONAL INSTABILITY IN ADOLESCENT PATIENTS BASED ON GLENOHUMERAL JOINT CAPSULE DIMENSIONS ON MR ANALYSIS	<u>Mason Yoder, BS</u> ; <u>Matthew W. Veerkamp, BA</u> ; <u>Colin McDonald, DO</u> ; <u>Shital N. Parikh, MD</u>
P66	ARTHROSCOPIC LABRAL REPAIR OF ADOLESCENT ATHLETE SHOULDER INSTABILITY WITH KNOTTED VERSUS KNOTLESS SUTURE ANCHORS	<u>Richard M. Michelin, D.O.</u> ; <u>Bryn Gornick, BS</u> ; <u>John A. Schlechter, DO</u>

SCIENTIFIC POSTERS

Located throughout the conference space, including the Legends pre-function and the Champions balcony/pre-function (2nd floor). Presenting authors are underlined.

SPORTS SPECIALIZATION		
P67	EPIDEMIOLOGY OF OVERUSE INJURIES IN U.S. SECONDARY SCHOOL ATHLETICS FROM 2014-2015 TO 2018-2019 USING THE NATIONAL ATHLETIC TREATMENT, INJURY, AND OUTCOMES NETWORK SURVEILLANCE PROGRAM.	<u>Eric G. Post, PhD, ATC</u> ; <u>Janet E. Simon, PhD, AT</u> ; <u>Hannah Robison, MS, ATC</u> ; <u>Sarah N. Morris, PhD</u> ; <u>David Bell, PhD, ATC</u>
P68	SPORT PARTICIPATION AND SPECIALIZATION CHARACTERISTICS IN A PEDIATRIC SPORTS MEDICINE CLINIC	<u>Hannah M. Worrall, MPH, CCRP</u> ; <u>Savannah B. Cooper, MS</u> ; <u>Jacob Jones, MD</u> ; <u>Shane M. Miller, MD</u> ; <u>Jane Chung, MD</u>
STRESS FRACTURES-OVERUSE		
P69	TYPE VII TIBIAL TUBERCLE FRACTURES ARE DIFFERENT FROM OSGOOD-SCHLATTER SYNDROME AND TIBIAL TUBERCLE PHYSEAL FRACTURES	<u>James G. Gamble, MD, PhD</u> ; <u>Rati Shirodkar, BA, BS</u> ; <u>Jamison G. Gamble, MPH</u> ; <u>Charles M. Chan, MD</u>
P70	LOW-RISK FOOT AND ANKLE STRESS FRACTURES IN THE PEDIATRIC POPULATION: A CASE SERIES	<u>Matthew Gremillion, BS</u> ; <u>Ramesh B. Ghanta, BS</u> ; <u>Neritan Borici, MD</u> ; <u>Indranil Kushare, MD</u>
TIBIAL SPINE		
P71	WHAT ARE THE CAUSES AND CONSEQUENCES OF DELAYED SURGERY FOR PEDIATRIC TIBIAL SPINE FRACTURES?	<u>Neeraj M. Patel, MD, MPH, MBS</u> ; <u>Tomasina Leska, BS</u> ; <u>Theodore J. Ganley, MD</u> ; <u>Julien T. Aoyama, BA</u> ; <u>Aristides I. Cruz, Jr., MD, MBA</u> ; <u>Henry B. Ellis, Jr., MD</u> ; <u>Peter D. Fabricant, MD MPH</u> ; <u>Daniel W. Green, MD, MS, FACS</u> ; <u>Jason E. Jagodzinski, MD</u> ; <u>Benjamin Johnson, PA-C</u> ; <u>Indranil Kushare, MD</u> ; <u>R. Jay Lee, MD</u> ; <u>Scott D. McKay, MD</u> ; <u>Jason Rhodes, MD</u> ; <u>Brant Sachleben, MD</u>
P72	PEDIATRIC TIBIAL SPINE FRACTURES: EXPLORING CASE BURDEN BY AGE AND SEX	<u>Christopher J. DeFrancesco, MD</u> ; <u>Lauren Wilson, MPH</u> ; <u>Alexandra T. Mackie, BA, PB-BS</u> ; <u>Drake G. LeBrun, MD, MPH</u> ; <u>Stavros G. Memtsoudis, MD, PhD, MBA</u> ; <u>Peter D. Fabricant, MD MPH</u>
ULTRASOUND		
P73	ULTRASOUND ASSESSMENT OF SYNDESMOTIC INJURIES IN A PEDIATRIC POPULATION	<u>Marie-Lyne Nault, MD, PhD</u> ; <u>Pierre-Henri Heitz, MSc</u>

EPOSTERS

ACL		
EP1	THE RELIABILITY OF TWO DIMENSIONAL KINEMATIC ASSESSMENT OF A 45-DEGREE SIDE STEP CUT	<i>Lauren Butler, PT, DPT, SCS</i> ; Alexa Martinez, PT; Dai Sugimoto, PhD, ATC; Charles W. Wyatt, MS, CPNP, RNFA; Eryn K. Milian, PhD, DPT; Alex Loewen, MS; Ashley Erdman, BS, MBA; Sophia Ulman, PhD; Kristin Hayden, DPT; Amie DeVerna, PT, DPT, PCS; Kirsten Tulchin-Francis, PhD
EP2	PHYSICIAN PREFERENCES ON BONE AGE DETERMINATION FOR ANTERIOR CRUCIATE LIGAMENT (ACL) RECONSTRUCTIONS FOR PEDIATRIC PATIENTS WITH ACL INJURIES	Emily Nice, BS; Corinna C. Franklin, MD; Eric Heidel, PhD; <i>Carlos A. Uquillas, MD</i>
EP3	KNEE STRENGTH OUTCOMES IN ADOLESCENTS BY AGE AND SEX DURING LATE-STAGE REHABILITATION AFTER ANTERIOR CRUCIATE LIGAMENT RECONSTRUCTION	<i>Dylan P. Roman, PT, DPT</i>
EP4	SEX DIFFERENCES IN MUSCLE ACTIVATION PATTERNS ASSOCIATED WITH ANTERIOR CRUCIATE LIGAMENT INJURY DURING LANDING AND CUTTING TASKS: A SYSTEMATIC REVIEW	Reiko Otsuki, PhD; Michael J. Del Bel, PhD(c); <i>Daniel L. Benoit, PhD</i>
CONCUSSION		
EP5	SACCADIC LATENCY MEASURES ON OCULOMOTOR TRACKING AND KING DEVICK TESTING PERFORMANCE MEASURES IN PEDIATRIC CONCUSSION PATIENTS	<i>Saikaashyap Sarva, BS</i> ; Prem K. Thirunagari, BSHS, BS; Hector Rierio, PhD; Matthew Bell, DO; Leslie Streeter, NP-C; Jonathan Minor, MD; Arvind Balaji, MD; Brett Dusenberry, MD; Mo Mortazavi, MD
EP6	AN ANALYSIS OF THE INCREASED RISK FOR LOWER EXTREMITY INJURY WITHIN 12 MONTHS AFTER CONCUSSION AND UTILIZATION OF LOWER EXTREMITY MEASURES FOR RETURN TO SPORT.	<i>Claire Switzer, PT, DPT</i> ; Nicole E. Melfi, DPT, ATC, SCS; Katy Mitchell, PT, PhD; Robert Hofschulte, PT, DPT; Purvi Vora, PT, DPT
MENISCUS		
EP8	NEGATIVE PREDICTIVE VALUE OF MRI-DETECTED MEDIAL MENISCUS TEARS IS REDUCED IN YOUNG ATHLETES WITH CHRONIC ACL INJURY	<i>Joseph Sliepka, MD</i> ; Mia S. Hagen, MD; Shamele Battan, BS; Chris Kweon, MD; Albert Gee, MD; Gregory A. Schmale, MD; Michael Saper, DO, ATC, CSCS
EP9	MENISCUS TEAR TYPES AND EARLY FAILURES IN PEDIARIC PATIENTS: DESCRIPTIVE EPIDEMIOLOGIC ANALYSIS FROM THE SCORE MULTI-CENTER QUALITY IMPROVMENT PROJECT.	Navya S. Peddireddy, BS; Lizzie R. Adsit, MHA; Savannah B. Cooper, MS; Matthew D. Milewski, MD; Benton E. Heyworth, MD; Eric W. Edmonds, MD, FAOA; Donna Pacicca, MD; Richard E. Bowen, MD; Christian Clark, MD; Jennifer Brey, MD; Emily Niu, MD; Stephen Storer, MD; Kevin Shea, MD; <i>Henry B. Ellis, Jr., MD</i>
OCD ELBOW		
EP10	PROGRESSION TO SURGERY IN ADOLESCENT OSTEOCHONDRITIS DISSECANS OF THE ELBOW	<i>Brionna Sandridge, BS</i> ; David R. Howell, PhD; Jay Albright, MD
OCD KNEE		
EP11	OPTIMAL SCREW LENGTH FOR OSTEOCHONDRITIS DISSECANS FIXATION OF THE PEDIATRIC DISTAL FEMUR: A MAGNETIC RESONANCE IMAGING COMPARISION STUDY OF PEDIATRIC EPIPHYSEAL THICKNESS	<i>Gabriel G. Sampognaro, BS, MS, MD</i> ; Patrick Massey, M.D.; Bradley Nelson, MD; Patrick Ingrassia, BS; Alberto Simoncini, MD; Shane Barton, MD
MENTAL HEALTH		
EP12	ELEVATED ANXIETY AND DEPRESSION SYMPTOMS IN INJURED AND UNINJURED ADOLESCENTS	<i>Julie A. Young, ATC</i> ; Ellee Allison, student; Drew Mohr, BS; Andrea E. Bonny, MD; Amy E. Valasek, MD, MSc; James Onate
PATELLOFEMORAL INSTABILITY		
EP13	THE INCIDENCE OF RECURRENT INSTABILITY AFTER MEDIAL RETINACULAR REPAIR, QUADRICEPS TENDON FEMORAL LIGAMENT RECONSTRUCTION, AND THE ROUX GOLDTHWAIT PATELLAR TENDON TRANSFER FOR PATELLAR INSTABILITY	Jenna-Leigh Wilson, MD; Edward M. Wojtys, MD; Aaron Sciascia, PhD, ATC; <i>Eileen A. Crawford, MD</i>
SHOULDER INSTABILITY		
EP14	RETURN TO SPORT TESTING AFTER ARTHROSCOPIC SHOULDER SURGERY IN ADOLESCENT PATIENTS	<i>Kathryn G. Anderson, BS</i> ; Dylan P. Roman, PT, DPT; Shing Varakitsomboon, BS; Adam P. Weaver, PT, DPT; Michael Saper, DO, ATC, CSCS
SPINE SPONDYLOLYSIS		
EP15	PEDIATRIC RESEARCH IN SPORTS MEDICINE RESEARCH INTEREST GROUP SPINE/SPONDYLOLYSIS CLINICAL PRACTICE SURVEY	<i>Mark Riederer, MD</i> ; Suraj A. Achar, MD; Kevin J. McHorse, PT; James P. MacDonald, MD MPH

EPOSTERS

SPORTS SPECIALIZATION		
EP16	TRACK AND FIELD INJURIES IN CHILDREN AND ADOLESCENTS PRESENTING TO US EMERGENCY DEPARTMENTS-AN UPDATED REVIEW OF THE NATIONAL ELECTRONIC INJURY SURVEILLANCE SYSTEM	<i>Kyra Caldwell, MS</i> ; Nathan V. Houlihan, BS; Taraje Whitfield, Undergraduate; Brendan A. Williams, MD
EP17	SPORT SPECIALIZATION AND EXPOSURE IN A TERTIARY CONCUSSION PROGRAM	<i>Eileen P. Storey, MD</i> ; Stephen R. Master, MD, PhD; Naomi Brown, MD; Danielle Magrini, DO; Christopher Renjilian, MD; Christian Turner; Brian Vernau, MD, CAQSM; Theodore J. Ganley, MD; Kristy B. Arbogast, PhD; Matthew F. Grady, MD; Christina L. Master, MD
TIBIAL SPINE		
EP18	TYPE I TIBIAL SPINE FRACTURES: NOT SO SIMPLE TO CLASSIFY, NOT SO EASY TO TREAT. A MULTI-CENTER STUDY	<i>Jilan L. Shimberg, BA</i> ; Tomasina Leska, BS; Julian T. Aoyama, BA; Aristides I. Cruz, Jr, MD, MBA; Henry B. Ellis, Jr, MD; Peter D. Fabricant, MD MPH; Theodore J. Ganley, MD; Daniel W. Green, MD, MS, FACS; Benjamin Johnson, PA-C; Indranil Kushare, MD; R. Jay Lee, MD; Scott D. McKay, MD; Todd A. Milbrandt, MD; Neeraj M. Patel, MD, MPH, MBS; Jason Rhodes, MD

FACULTY LISTS AND FINANCIAL DISCLOSURES

Adam Saloom, DPT
Alex Loewen, MS
Alexa Martinez, PT
Alfred Mansour, MD
Allison Crepeau, MD
Amy L. Xu, BS
Amy Rabatin, MD
Andrew Block, BS
Andrew Pennock, MD
Andrew Watson, MD
Ashley N. Triplett, PhD
Ashok Para, MD
Aubrey Armento, MD
August M. Price, PsyD
Benjamin Johnson, PA-C
Benjamin R. Wilson, MD
Benton E. Heyworth, MD
Bianca Edison, MD MS FAAP
Bianca Marois, MSc
Brandon W. Barsky, MD
Brendan A. Williams, MD
Brian Haus, MD
Brionna Sandridge, BS
Caitlyn E. Smith, BA
Carlos A. Uquillas, MD
Charles M. Chan, MD
Chimsom Oleka, MD
Chris Kuenze, PhD, ATC
Christin M. Zwolski, PT, DPT, OCS
Christina L. Master, MD
Christine S. Ellis, MSN
Christopher Kuenze, PhD, ATC
Chuck Wyatt, MS, CPNP, RNFA
Cindy Benzon
Claire Switzer, PT, DPT
Cliff Willimon, MD
Colin M. Huber, BS
Connor M. Carpenter, BBA
Cordelia Carter, MD
Corinna C. Franklin, MD
Cornelius Groenewald, MD
Crystal Perkins, MD
Dan Green, MD
Daniel L. Benoit, PhD
Daniel W. Green, MD, MS, FACS
Danielle E. Jewell, BSN in Progress
Danika Baskar, BA
Dennis E. Kramer, MD
Donna Merkel, PT MS SCS CSC
Donna Pacicca, MD
Dylan P. Roman, PT, DPT
Eileen A. Crawford, MD
Eileen P. Storey, MD
Eli C. Epstein, PT
Elizabeth (Liz) Victor Franklin, PhD
Elizabeth Franklin, PhD
Elliot Greenberg, PT, PhD
Emily E. Wolfenden, MD MPH
Emily Finanger, PT
Emily Kraus, MD
Emily Niu, MD
Emily Sweeney, MD
Eric G. Post, PhD, ATC
Eric Pridgen, MD, PhD
Erin Fernandez, ATC, LAT
Frank Parilla, MD
Gabriel G. Sampognaro, BS, MS, MD.
Gary Calabrese, DPT, PT
Gregory A. Schmale, MD
Gregory A. Walker, MD, FAAP, CAQSM
Henry B. Ellis, Jr, MD
Indranil Kushare MD
Jacob Jones, MD
James A. Pruneski, BS
James G. Gamble, MD, PhD
James Pace, MD
Jane Chung, MD
Jason Rhodes, MD
Jeannie Perkis, DPT
Jeffrey J. Nepple, MD
Jeffrey Shilt, MD
Jennifer Beck, MD
Jerry Clayton, PhD
Jessica Dabis, DPT
Jessie R. Oldham, PhD
Jilan L. Shimberg, BA
Jo Janosky, DPHc, MS, PT, AT
Joe Chorley, MD
John A. Schlechter, DO
John Schlechter, MD
Jonathan Napolitano, MD
Jonathan Santana, MD
Jorge Gomez, MD
Joseph Chen, MD
Joseph Gibian, MD
Joseph Sliepka, MD
Joshua Choe, MS
JR Cruz, MD
Julia Drattell, ATC
Julie A. Young, ATC
Julie C. Wilson, MD
Julie Dyke, DPT, SCS
Julie Johnson, PT, MPT, SCS, CSCS
Justin S. DiSanti, PhD
K. John Wagner, III, BS
Kari Lindegren, PT, DPT, OCS
Karina Oganezova, BS
Katherine Rizzone, MD
Katherine Smulligan, PT, DPT
Kathleen Harwood, BS
Kathryn G. Anderson, BS
Kayla Panos, DPT
Keith May, PT, DPT, SCS, ATC
Kelsey Everhart, MS, ATC
Kelsey L. Griffith, MS
Kevin Shea, MD
Kevin Wilk, DPT
Kirsten Tulchin Francis, PhD
Kristin Ernest, MD
Kyle C. Chesler, BS
Kyle L. McCormick, MD
Kyle Nagle, MD
Kyra Caldwell, MS
Laura Boucher, PhD, ATC
Lauren Butler, PT, DPT, SCS
Lauren Redler, MD

FACULTY LISTS AND FINANCIAL DISCLOSURES

Lee Pace, MD
Liane Chun, MD
Lisa Ek Orloff, MSc Student
Louis Nicolosi
Luke C. Radel, MD
M Sanchez, BS
Madison Brenner, BSA
Manny Economos, ATC
Marian Abowd, MS, LAT, ATC
Marie-Lyne Nault, MD PhD
Mark Fisher, MD
Mark Halstead, MD
Mark Riederer, MD
Mark Tompkins, MD
Mary Dubon, MD
Mason Yoder, BS
Mathew J. Wingerson, MS
Matt Ellington, MD
Matt Grady, MD
Matthew Bell, DO
Matthew D. Milewski, MD
Matthew Gremillion, BS
Matthew Sacco, PhD
Melissa Christino, MD, FAAOS
Mia J. Katzel, DPT
Micah C. Garcia, MS
Michael J. Del Bel, PhD(c)
Michael Saper, DO, ATC, CSCS
Michelle Fearheller, DPT, OCS, SCS, CSCS
Mininder S. Kocher, MD MPH
Monica C. Pita, Athletic Training
Neeraj M. Patel, MD, MPH, MBS
Nicholas A. Strada, ScB
Nicholas D. Thomas, MS
Nicholas G. Giampetruzzi, PT, MSPT
Nicholas J. Romanchuk, MSc
Nicholas K. Purcell, PT, DPT, SCS
Nicole Friel, MD MS
Nicole Melfi PT, DPT, SCS, ATC
Nirav Pandya, MD
Pam Wilson, MD
Patricia R. Roby, PhD, ATC
Paul Saluan, MD
Peter D. Fabricant, MD MPH
Philip A. Serbin, MD
Philip L. Wilson, MD
Prem K. Thirunagari, BSHS, BS
Reid P. Schlesinger, BS
Richelle M. Williams, PhD
Ryan M. Sanborn, BA
Sabah B. Ali, BS
Saikaashyap Sarva, BS
Salvador Ayala, B.S.
Samantha N. Magliato, BS
Samuel M. Lyons, M.S.
Sarah Dobkins, MS, RD, CSSD, LD
Sarah Fogleman, MD
Sasha Carsen, MD
Scott D. McKay, MD
Scott Passalugo, Bachelor of Science
Seth L. Sherman, MD
Shane M. Miller, MD
Sharon G. Huang, BA
Shelby Baez, PhD, ATC
Shital N. Parikh, MD
Siddharth Jadhav, MD
Sophia Ulman, PhD
Soroush Baghdadi, MD
Stephanie Logterman, MD
Stephanie S. Pearce, MD
Stephanie Tow, MD
Stephanie W. Mayer, MD
Tamara C. Valovich McLeod, PhD, ATC, FNATA
Teresa E. Flaxman, MSc PhD
Theodore Ganley, MD
Timothy A. McGuine, PhD ATC
Todd Caze, II, PhD
Tom Iannetta, ATC, CSCS
Traci Snedden, PhD, RN, CPNP
Valerie Parrish, PA-C
Yi-Meng Yen, MD PhD

PRISM LEADERSHIP

BOARD OF DIRECTORS

PRESIDENT

Matthew Milewski, MD

FIRST VICE PRESIDENT

Cordelia W. Carter, MD

SECOND VICE PRESIDENT

David R. Howell, PhD

TREASURER

Daniel W. Green, MD

TREASURER-ELECT

Corinna Franklin, MD

SECRETARY

Nirav K. Pandya, MD

SECRETARY-ELECT

Tamara Valovich McLeod, PhD, ATC, FNATA

PAST PRESIDENTS

Mark Paterno PT PhD MBA SCS AT-Ret.

Andrew Gregory, MD

DIRECTORS AT LARGE

Elliot Greenberg, DPT PhD

Kristina Parvanta Johnson, ATC

Katherine Rizzone, MD MPH

Jennifer Beck, MD

Henry B. Ellis, Jr, MD

Kristina Wilson, MD

SCIENTIFIC PROGRAM COMMITTEE

CO-CHAIRS

Scott McKay, MD

Traci Snedden, PhD, RN, CPNP

CO-CHAIRS ELECT

Lauren Butler, PT, DPT, SCS

Jay Albright, MD

MEMBERS

David M. Bazett-Jones, PhD, ATC, CSCS

Erica K. Schallert, MD

Kevin Latz, MD

John A. Schlechter, DO

Courtney N. Gleason, MD

Corinna C. Franklin, MD

Emily A. Sweeney, MD

Micheal Beasley, MD

Donna Merkel, PT

PRISM STAFF

EXECUTIVE DIRECTOR

Kristin Haskin, MA

MEMBERSHIP AND ADMINISTRATIVE MANAGER

Heather Schrader, CAE

ACCOUNTANT

Christy Madore, CNAP

CONSULTING PARTNER

Kay Whalen, MBA, CAE

PRISM OFFICE

555 East Wells, Suite 1100

Milwaukee, WI 53202

Phone: 414.918.9876

Fax: 414.276.3349

Email: info@prismsports.org

NOTES

NOTES



PRISM 10TH ANNUAL MEETING
Denver, CO | FEB 2-4
HYATT REGENCY DENVER | 2023

A large background image of a mountain landscape at sunset or sunrise. The scene features a calm lake reflecting the surrounding forested mountains and the warm, orange and pink sky. The text 'SAVE THE DATE' is overlaid on the right side of the image in large, white, sans-serif capital letters.

SAVE
THE
DATE



PRISM
Pediatric Research in
Sports Medicine Society